

STYLE-RITE industries

ORNAMENTAL
ALUMINUM

**RAILINGS and
ROUND • SQUARE COLUMNS**



GAZEBO at LAKEVIEW LOUNGE, GREENSBURG, PA

Style-Rite Extruded Round and Square Aluminum Columns. The look of traditional wood with the durability, strength, and low maintenance features of aluminum. These columns are recommended for new homes, commercial buildings,

and replacement of wooden columns on older buildings of all types. Style-Rite Columns feature a baked-on enamel finish in white, brown, wicker, almond and pebble stone clay. All fittings are die cast and painted with state of the art powder coat finish.



Listed below are various diameters and lengths available.

ROUND COLUMNS		
Col Dia.	Standard Length	Approx. Weight Load*
6"	8' - 9' - 10' - 12'	20,300
8"	8 - 9' - 10' - 12' 16' - 18'	30,000
10"	8 - 9' - 10' - 12' 16' - 18'	42,600
12"	8 - 9' - 10' - 12' 16' - 18' - 20' - 24'	52,250
15"	8 - 9' - 10' - 12' 16' - 18' - 20' - 24'	55,000

SQUARE COLUMNS		
Col Dia.	Standard Length	Approx. Weight Load*
3"	8' - 10'	8,000
4"	8' - 10'	16,800
6"	8' - 10' - 12'	22,700
8"	8' - 10' - 12' - 16'	30,300
10"	8' - 10' - 12' - 16' - 20'	33,300
12"	8' - 10' - 12' - 16' 18' - 20' - 24'	35,500

* Maximum Load - No Safety Factor Included

6", 8" and 10" Round are Available in Brown, Almond, Wicker, and Clay. 12" Round is Available in Almond. Square 4", 6" and 8" are Available in Brown, Almond, and Clay. Square 6", 8" and 10" Available in Wicker. 10" are Available in Almond. 3" only in White, Black and Bronze.

Square Columns

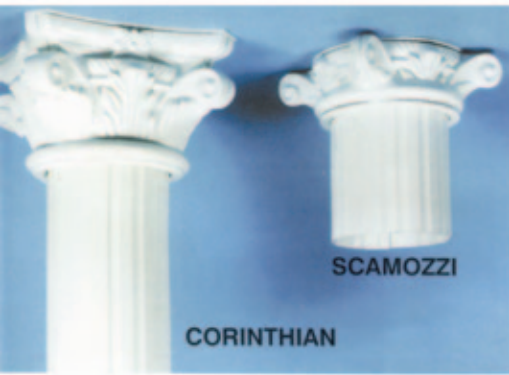

DECORATIVE CAPS

SCAMOZZI:

8" and 10"

CORINTHIAN:

8", 10", 12" and 15"



SMOOTH SQUARE NON FLUTED COLUMNS

6" x 8'	8" x 8'	8" x 16'
6" x 10'	8" x 10'	8" x 20'
6" x 12'	8" x 12'	

WHY USE STYLE-RITE ALUMINUM COLUMNS

1. Easy-to-assemble

Just cut to size, interlock sections, install fasteners, slip flange type caps over columns, and assembly is complete.

2. Permanent, trouble free

Style-Rite columns will not rot or split. Wear and weathering have little or no effect. Termite proof.

3. Load-bearing

Style-Rite columns will support patio covers, entrance canopies, covered walkways, and many other structures.

4. Light weight

Assembly is usually a one man operation. This cuts down on labor, material, and handling costs.

5. Finish

Baked-on, white enamel finish which resists chipping, flaking and peeling.

6. Homes

Porches, entrances, patios, foyers, room separators, and sun decks.

7. Apartment buildings

Balcony supports, canopies, hallways, lobby supports, and covered driveways.

8. Churches

Entrances, colonnades, and interiors

9. Shopping centers

Shop entrances, covered walkways, canopies, and other store decor.

10. Other uses

Office buildings, schools, motels, libraries, medical centers, and other commercial and residential structures.

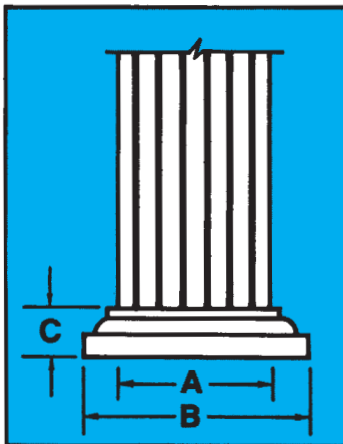

ROUND COLUMNS

SIZE	ACT. DIA.	CAP & BASE SIZE INCHES	
		A	B
6"	5½"	7"	1⅝"
8"	7½"	9⅞"	1¾"
10"	9½"	12⅛"	2¼"
12"	11½"	16"	3½"
15"	14½"	18⅓⅙"	3¾"

SQUARE COLUMNS

SIZE	ACT. SIZE	CAP & BASE SIZE INCHES	
		A	B
3"	2¾"	5½" X 4¾"	1¾"
4"	3¾"	5⅜"	1¾"
6"	5½"	7⅜"	1¾"
8"	7½"	9⅜"	1¾"
10"	9½"	11⅜"	2"
12"	11½"	13⅞"	2¾"

All aluminum bases are die-cast. 6" and 8" round base also available in PVC.

Porch and Step Railings

ECONOMICAL, MAINTENANCE FREE ALUMINUM RESIDENTIAL RAILING

Accent White Satin Black Walnut Brown
Almond Pebble Stone Clay

- EASY TO INSTALL
- DESIGNED FOR PORCH OR STEPS
- BEAUTIFUL INDOORS AS WELL AS OUTDOORS



DO IT YOURSELF

Complete Installation Instructions are packed with each article.

BLACK, WHITE, WALNUT BROWN, ALMOND or PEBBLE STONE CLAY Baked Enamel. All Railing Sections Assembled.
GATES AVAILABLE ON REQUEST.

R-103 - 3 ft. Rail Section
R-104 - 4 ft. Rail Section
R-105 - 5 ft. Rail Section
R-106 - 6 ft. Rail Section
R-107 - 7 ft. Rail Section
R-108 - 8 ft. Rail Section
R-112 - 12 ft. Rail Section

Standard rail height 30" - 24"
Picket - 6" ext. Picket.

Other Sizes Available
Rail height 36" - 30" Picket - 6" ext. Picket.
Rail height 36" - 34" Picket - 2" Ext. Picket.

Standard Picket Centers is 6".
Pickets on 4" centers are also available in all rail heights.



NP 31 Newel Post
NP 36 Newel Post
NP 38 Newel Post

Extruded 1½" Aluminum Tubing.

Available in 31", 36" and 38" lengths.



A-205
Crossover Cap

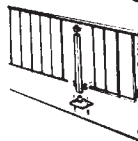

For connecting rails over posts or for support of long rail sections.

CODE RAILING

in White, Black, Almond, Clay and Brown



Height is 36",
pickets 4" on center.

All accessories are interchangeable with the standard rail.

A-204



Lamb's tongue gives finished decorative effect to Newel Posts.

A-207
Diamond Scrolls



Centered on picket as shown.

A-206
Heart Scrolls



A-203

Center support flange.
Used with 4, 5, 6, 7, 8, and 12 foot sections for surface mounting or combining long ½" square center picket.

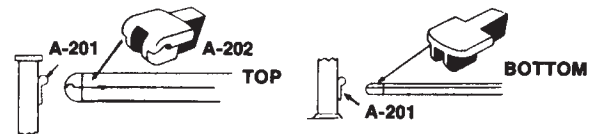

A-201 Straight Rail Connectors

Package includes:

- 4 — Polycarbonate mountings for fastening rail to post.
- 4 — Aluminum binding posts and screws (13/64" — #4 drill)

- 8 — Self tapping screws #8 x 5/8" Phillips head for fastening cast mounting to post (7/32" — #2 drill).

Used to connect railings to post, columns or walls with railing mitered for steps or rail ends square cut for porch or patio.

A-202 Pitched Rail Connectors

Package includes:

- 1 — Polycarbonate mounting for top rail
- 1 — Polycarbonate mounting for bottom rail
- 2 — Aluminum binding posts

Ornamental Columns SUPPORT AND DECORATE

Columns also are completely maintenance free with all heavy gauge aluminum construction.

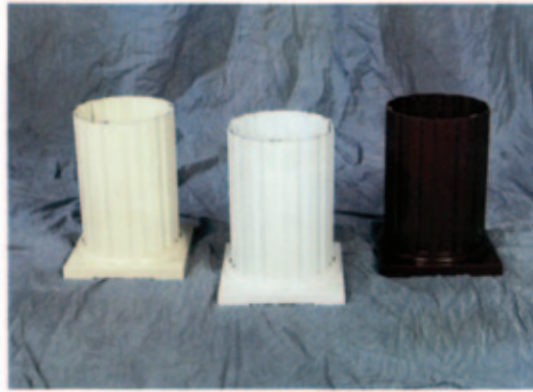

Round and square column colors - white, brown, almond, or pebble stone clay or can be painted any desired color. Vinyl acrylic paint is recommended.



Flat and corner column mounting plates are made of heavy-painted cast aluminum, and are attached to the column.

Columns Available in 8 ft. and 10 ft. Lengths by 9 inch widths. Both the corner and flat column are structurally designed for roof structure support strength. Flat - 7,000 lbs., Corner - 11,000 lbs.

COLUMN MOUNTING PLATES AVAILABLE IN THESE VARIOUS STYLES

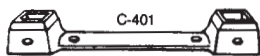

C-401
Flat Mounting Place

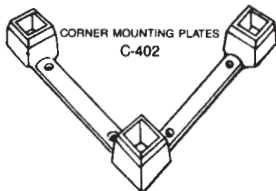

C-402
Corner Mounting Plates

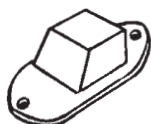

C-403
Adjustable Mounting Castings

STYLE-RITE HAND RAILING

Available in:

- HR-308 — 8 ft.
- HR-312 — 12 ft.
- HR-316 — 16 ft.

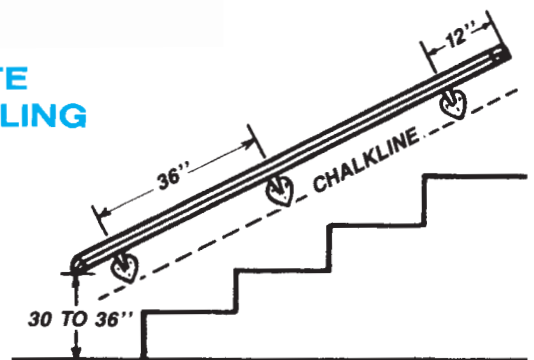

HR-301
Hand Rail Wall Mounting Bracket with Binding Screws. Use every 3 feet. No wall fasteners included.



H-302
Extra Hand Rail End Knobs (Set of 2 with Binding Screws.) Used with Top Rail and #76104 mounting brackets.

Assembly and Installation

Style-Rite Columns are suitable for both new construction and for wraparound installations; the figures below have been prepared accordingly. Figures 1, 2 and 3 are common to both applications and should be closely followed for a proper installation. Figures 4a and 4b cover wraparound, while figures 5a and 5b are for new applications.

NOTE: 12" and 15" round columns do not have wraparound features.

INSTALLATION

Columns install easily and quickly, around existing columns or independently, affording added versatility. The "snap lock" feature fastens the sections and makes them fast. Packed one column per carton, caps and bases in master cartons.

Recommended installation procedures are shown below and to the right for both new construction and "wraparound" work and should be carefully followed for a suitable application.

1. Measure required height (NOTE: for new construction, add 1/4" to measured height. For wraparound installation, subtract 1/4" from measured height) and cut column staves with a hacksaw prior to assembly.
2. Assemble staves by rotating together.
3. Assemble final interlock by rapping with the heels of the hands, starting at one end of the column.

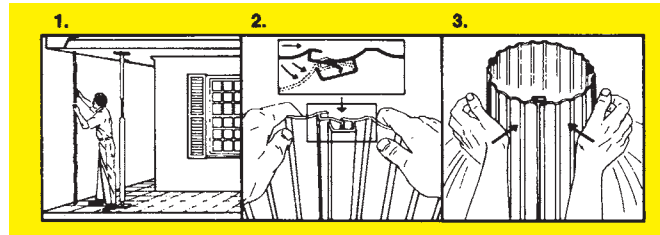

NOTE: Square column assembly instructions are basically the same as the round column. **12" round column assembly - See Instructions.**

WRAPAROUND

4a. Cut base with hacksaw along diagonal, splitting lugs on underside of base. Place 1/2 of the split base around column, so that edge is parallel to edge of structure. Plumb column and align cap and base identification mark along a single column flute. Fasten column top and bottom with two angle brackets with either screws or rivets.

4b. Place second 1/2 of split base and cap around column and drill four 1/8" holes through base and cap and into column, in line with rib. Fasten with #8 x 1" sheet metal screws as in figure 5b.

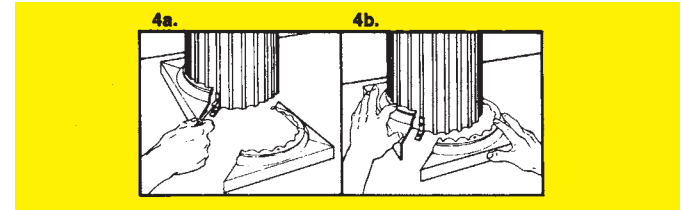

NEW CONSTRUCTION

5a. Slide cap and base on column ends. To avoid scratching of column, slide base on until bottom is flush with end of column. NOTE: Align square cap and base identification mark along a single column flute. Raise structure 1/2" to permit plumb installation of assembled column. Lower structure to secure column.

5b. Drill four 1/8" holes, equally spaced, through base and into column, in line with rib. Fasten with #8 x 1" sheet metal screws.

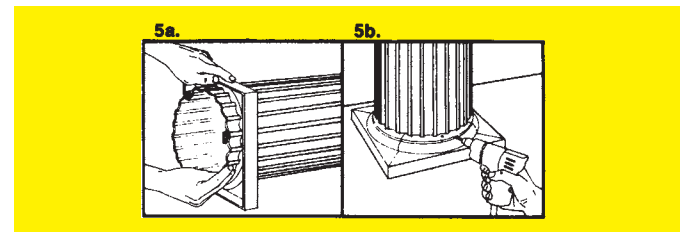

**Assembly for
12" and 15" Round
Column Only**

1.	2.	3.	4.	5.
Join sections together, small hooks curling into large hooks.	Join all sections in this way except one.	Slide final section into place, tapping gently with rubber mallet, if necessary.	Slide base and cap onto column. Set column in place and plumb with level.	Slide base and cap into finish position: remove props.

Planning Your Railing Installation

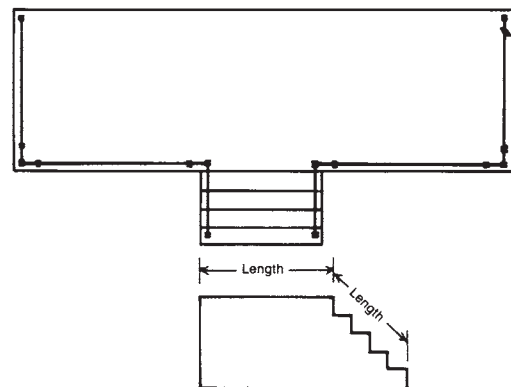

1. Adjustable rail sections may be used for either level platform or steps. Posts mount on any surface.
2. Draw line on platform to indicate where railing is to be installed. Line should be 3" or 4" in from edge of platform and side of steps.
3. Measure length of railing required in order to determine number of newel posts required.
 - a. Factory assembled sections may be combined to make up any length desired.
 - b. A 1 1/2" square newel post is used between each section.
 - c. On long railing installations use a newel post every 6 ft. for recommended strength.
4. Mark locations of end, intermediate or corner newel post. Remember if used include 9" Heart or Diamond Column.
5. Step Rail is measured from tip of porch to tip of bottom step and then subtracting 1 1/2". This will then be length of railing.
6. For steps the top and bottom rail ends can be cut to the desired angle with a hacksaw. However, optional connectors are available which will automatically adjust to the correct angle for all steps. Complete assembly and installation instructions are to be found in each rail package.