



PRICING & SPECIFICATIONS

v.2 Effective August 1, 2016
Supersedes All Prior Versions



2016 Price Book Update Summary

August 2016

- Pg. 4 – Zone cut-off dates and times adjusted
- Pg. 6 – 5-piece drawer front option added to order form
- Pg. 9 – Lawrence door front has Mortise & Tenon construction
- Pg. 11 – Typo fixed 'Made in the USA'
- Pg. 74 – Small cove molding list price adjusted from \$130 to \$202
- Pg. 76 – Individual color blocks available in maple only, price book SKU updated
- Pg. 77 – DSK-CS now includes list of door styles and finishes

CONTENTS



General Information

Contact Information	1
Policies & Procedures	2-5
Capital Series Order Form	6
Product Awareness	7
Door Styles	8-9
Cabinet Specifications	10-11
Finishes	12-13
Finish Agreement	14
Cabinet Care and Cleaning	15
Custom Modifications	16-18

Cabinets

Wall Cabinets	20-33
Base Cabinets	36-44
Universal Access Cabinets	46-53
Tall Cabinets	54-59
Vanity Cabinets	60-69

Accessories & Details

Wall Accessories	34-35
Base Accessories	45
Details	70-73
Molding	74-75
Marketing Tools	76-77
Replacement Parts	78

Warranty	79
----------	----



INDEX BY NOMENCLATURE

3012-4242	12" - 42" High Wall Cabinets	20-25
ACH30-36	Arch Canopy Wood Hood	34
B12-B48	Base Cabinets	36-37
B3/4	Batten Molding	74
BB10	Bar Bracket	35
BEP-BEP6	Base End Panel	45
BLS36	Base Lazy Susan - 1/2" Overlay	40
BM	Base Molding	75
BMC27-BMC36	Base Microwave Cabinet	44
BS	Base Skins	70
BT9	Base Tray Divider Cabinet	36
BTD12-BTD36	Base Triple Drawer	38
BWPS24-BWPS36	Base Cabinet w/ Pullout Shelves	38
CAP	Cap Molding	75
C2430-C4842	Blind Corner Wall	29-31
C3/4	Corner 3/4 Molding	74
CB36-CB48	Corner Blind Base	43
CE	Counter Edge Molding	75
CF3-CF342	Corner Filler	71
CM8-CM10	Crown Molding 8 & 10	74
CS33-CS36	Corner Susan Base	41
CSB33-CSB36	Corner Sink Base	41
CVS24B-CVS3618B	Combination Vanity Sink Base	62
CVS24BT-CVS3618BT	Tall Combination Vanity Sink Base	68
DC2430-DC2742	Diagonal Corner Wall	27
DCSB36	Diagonal Corner Sink Base	38
DCSF-DSCF42	Diagonal Corner Sink Front	35
DEP	Desk End Panel	45
DO3084-DO3696	Double Oven Cabinets	57
DS2430-DS2742	Diagonal Corner Susan Wall	27
F3-F696	Fillers	71
FBP4896-FBP9648	Finished Back Panel	71
FSFK	Framed Sample Fronts	77
IC3/4	Inside Corner 3/4 Molding	74
IM135	135° Inside Molding	75
LNRWH30-36	Liner (Canopy Hood)	34
LRM	Light Rail Molding	74
MBEP	Matching Base End Panel	44
MTEP1284-MTEP2496	Matching Tall End Panel	59
MVEP-MVEP18	Matching Vanity End Panel	64
MVEPT-MVEP18T	Tall Matching Vanity End Panel	69
MW2730-MW3042	Microwave Wall	28
MWEP30-MWEP42	Matching Wall End Panel	33
O2784-O3396	Oven Cabinets	56
OBL36	Base Lazy Susan - 1 9/16" Overlay	40
OD27-OD33	Oven Drawer	55
OCM	Outside Corner	75

INDEX BY NOMENCLATURE



OM135	135° Outside Molding	75
PB36-PB48	Peninsula Base Cabinets	40
PRICE-CS	Price Book - Capital Series	76
PW3018-PW3630	Peninsula Wall Cabinets	32
REP2484E-REP2496E	Refrigerator End Panel - Edgebanded, 3/4"	72
REP2484-REP2496	Refrigerator End Panel	72
RBM	Round Base Molding	75
RM	Rope Molding	74
RW3312-RW3924	Refrigerator Walls	26
S1 1/4	Scribe 1 1/4 Molding	74
S3/4	Scribe 3/4 Molding	74
SCB54-60	Corner Blind Sink Base	43
SCH30-36	Straight Canopy Wood Hood	34
SCVMD	Small Cove Molding	74
SCW2430-SCW2442	Square Corner Wall	31
SD	Sample Doors	76
SF24-SF36	Sink Front	39
SFF24-SFF4242	Sink Front Flooring	45
SHV	Shelving	71
SK1812-SK3624	Shelf Kits	72
SM	Shoe Molding	75
SRB24-SRB48	Sink/Range Base Cabinets	37
SSB36	Super Susan Base	42
SSK15-SSK24	Sliding Shelf Kits	73
TC18	Trash Can Base Cabinet	44
TRI-CS	Trifold-Capital Series	76
TSC4 1/2	Toe Space Cover	72
TSC8 1/2	Universal Access Toe Space Cover	52
TUK	Touch Up Kit	76
U181284-U362496	Utility Cabinets	58
UAB12-UAB36	Universal Access Base Cabinets	46
UABFH18-UABFH36	Universal Base Cabinet with Full Height Door	47
UABMC27-UABMC36	Universal Access Base Microwave	50
UACB36-UACB48	Universal Access Corner Blind Base	51
UACSB33-UACSB36	Universal Access Corner Sink Base	49
UADB12-UADB24	Universal Access Drawer Base	48
UADCSB36	Universal Access Diagonal Corner Sink Base	50
UAFSB30-UAFSB36	Universal Access Floating Sink Base Cabinet	47
UAMBEP	Universal Access Matching Base End Panel	52
UAO3084-UAO3684	Universal Access Oven Cabinets	53
UASSB36	Universal Access Super Susan Base	49
UATC15	Universal Access Trash Base Cabinet	52
UCM8	Universal Crown Molding	74
UMW3030-UMW3042	Universal Microwave Wall	28
US2496	Utility Skins	70
USK18-USK36	Utility Sliding Shelf Kits	73
V48-V72	Straight Valance	35
VB12-VB2418	Vanity Bases	60
VB12T-VB2418T	Tall Vanity Bases	66
VDB12-VDB2418	Vanity Drawer Base	61



INDEX BY NOMENCLATURE

VKD36-VKD3618	Vanity Knee Drawer	64
VNT-01	Ventilator (250 CFM)	34
VS-18VS	Vanity Skins	70
VS24B-VS3618B	Vanity Sink Base with Drawer Blanks	61
VS24BT-VS3618BT	Tall Vanity Sink Base with Drawer Blanks	67
VS24-VS3618	Vanity Sink Base	60
VS24T-VS3618T	Tall Vanity Sink Base	66
VS36-VSB5418	Vanity Sink Base with Drawers	61
VS36T-VSB5418T	Tall Vanity Sink Base with Drawers	67
VSD60-VSD6018	Combination Vanity Sink Drawer Base	62
VSD60T-VSD6018T	Tall Combination Vanity Sink Drw Base	68
VSDE57-VSDE5718B	Vanity Sink Base Extended Stiles	63
VSDE57T-VSDE5718BT	Tall Vanity Sink Base Extended Stiles	69
VSSK15-VSSK2418	Vanity Sliding Shelf Kits	73
VTD12T-VTD2418T	Tall Vanity Triple Drawer Base	65
WR2430-WR3018	Wine Racks	35
WS42	Wall Skins	70

CONTACT INFORMATION



2212 Airport Blvd.
Alexander City, AL 35010
(800) 846.2562

To Order, Email or Fax

Orders are accepted 24 hours a day by fax or by email on the Americana Capital Series order form or a computer design program (2020 Design & ProKitchen)

	EXT.	EMAIL	DIRECT FAX
--	------	-------	------------

ACCOUNT SERVICES

ACCOUNT REP			
Carla Vickers	233	cvickers@wellbornforest.com	256.215.3303
Tracey Denney	227	tdenney@wellbornforest.com	256.215.3325



POLICIES & PROCEDURES

General Policy Statement

Wellborn Forest conducts business in a fair and equitable manner toward maintaining customer satisfaction.

Credit Management

A signed and complete credit application must be received and approved to establish an account and to place orders for Americana Capital Series (CS). All credit references are checked and a credit bureau investigation is completed to determine the credit worthiness of the company and/or principals. If insufficient credit history or incomplete information exists, additional references, financial statements or other pertinent information may be requested.

Billing terms will be established once credit is approved. Violation of the established terms may result in a change to the terms or a credit hold. Quick pay 2% discounts are applied to purchased items only excluding freight and taxes.

Orders submitted are subject to review by the credit manager. Orders will be withheld from customers with past due accounts or balances in excess of established credit limits at our discretion. The credit manager will release orders when account payment issues are resolved. Production will be based on order release, not order placement.

We respectfully request our customers refrain from making unapproved payment deductions from invoices for damaged, defective or shorted items. Reconciliation of your account may result in your account being placed on credit hold if you make deductions. Discuss any adjustments to your account with your sales representative.

WFex

The WFex program is for customers requesting shelf items.

- Orders may be submitted daily by 11:00 AM CST
 - WFex must be checked on the order form. No order will be entered WFex without the WFex box marked, no matter how small the order.
 - A 20% upcharge will apply to non-warranty orders
 - Orders entered as WFex will be available for shipment in 4 business days (for non purchased items)
 - Freight charged minimum \$80, LTL carrier rate or UPS rate
- Limited to parts ONLY

The customer must designate UPS, LTL carrier or next available WF Truck on the order. If the customer does not designate shipping method, the best method of shipping will be determined.

Delivery

The transportation department notifies customers via fax/email the week prior to delivery. Delivery will be made either morning or afternoon. Contact transportation department (ext. 337) for delivery information if you have not received delivery notification. ETA available to view on www.mywfpdata.com. Specific delivery times cannot be arranged, however, fleet drivers are to contact customers 24 hours prior to delivery.

Wellborn Forest delivers only to the customer's place of business. Job site deliveries are prohibited by the size of trailers and liability concerns.

Wellborn Forest drivers will assist in tailgating the product. The dealer must furnish personnel to unload and check off the shipment.

Customers will be notified in the event of delivery delays resulting from mechanical breakdowns, production delays and other circumstances beyond our control.

Note: Requests to delay shipments from the acknowledged delivery date may incur storage fees. Customer Pickup items will be invoiced once produced and a storage fee may be applied if left at the WFP location for more than 1 week.

Freight

Truckload

***All deliveries are sold f.o.b. factory**

Contract carriers may be utilized for truckload deliveries. Truckload freight rates may be obtained by contacting the transportation department at Wellborn Forest **(ext. 337)**.

- Maximum Cubic Feet Per Truckload
 - 48' Trailer - 2700 cubic feet
 - 53' Trailer - 3200 cubic feet

Once loaded, truckload shipments held at the plant by the customer for delivery will incur a \$100.00 per day demurrage fee from the date the order is ready to ship.

Customers requesting expedited shipment (overnight or second day delivery) of replacement item(s) will be responsible for freight charges. These charges will be invoiced to the customer.

Cycle Trucks (Kitchens)

Product shipped on a Cycle truck is sold at the factory cost multiplier and freight charges are calculated at a per cabinet freight rate, based on the ship to location, incurred at invoicing. **Fuel surcharge may be applicable based on percentage of freight cost.**

Cabinets are charged the per cabinet rate, not accessories, moldings, etc. The per cabinet freight rate may be obtained through account services or your sales representative.

A minimum freight charge of \$80.00 will apply to shipments of less than five cabinets.

Orders loaded on the cycle truck and held for shipment by the customer or credit department will incur a **\$150.00 redelivery charge**.

UPS Shipments

All UPS shipments will be charged freight plus a \$10 handling fee.

Cabinets and all cabinet parts exceeding 70 lbs., 108" in length, or 165" in size combining length and girth cannot be shipped UPS.

POLICIES & PROCEDURES



Three Year Limited Warranty

Warranty claims are different than Damaged or Defective Goods claims. Warranty claims are made after the product is installed. Refer to Americana Capital Series Three Year Limited Warranty for complete warranty details. If you are making a Warranty Claim, check and fill out the Warranty Service Request box on the Americana CS Order form. Be sure to complete all information on the order form and fax it to account services. This order will be processed to produce on the next date of order placement and ship on the next available Wellborn Forest truck, LTL carrier or UPS.

Warranty orders may require field inspection and a signed authorization from our sales representative. All Warranty Service Request orders will be invoiced at the standard cost plus freight.

NOTE: A credit will not be issued until a warranty order has been invoiced. We are crediting the original, not the replacement. Disposition of the defective product may include returning it to Wellborn Forest. **If return of the item is requested, see Return Material Authorization (RMA) policy.**

Damage

If a product has been determined damaged beyond use while unloading, or with visible damage at the time of unloading use the Americana CS Order Form to submit orders for product. A "Damage Replacement" check box is available to you to order replacement items. Please provide the original order number in the field indicated. Product noted on the BOL/Shipper and ordered under these circumstances will be shipped at no charge. **If this information is not provided at time order is placed, items will be charged and freight assessed.**

If only the door is damaged, order only the door. If only the box is damaged, order the box only. If a component part will remedy the damage (i.e. drawer, drawer guide, hinge or shelves) order the necessary component. This will greatly speed the replacement process.

All replacements for damage, including parts, reported within the 30 days of invoicing will be shipped at no charge. We will determine the best method to ship the replacement item(s), including the preferred Cycle Truck.

Customers requesting expedited shipment (overnight or second day delivery) of replacement items will be responsible for freight charges. These charges will be invoiced to the customer. Note the damage on the Bill of Lading (BOL/Shipper) and obtain the driver's signature and contact account services immediately to reorder the damaged item(s).

Refer to the appropriate type carrier below to determine disposition of the damaged item. If delivered by:

- Wellborn Forest Company Owned Truck
 - return the item on the truck
- Contract Carrier Independent Carrier
 - accept the item since the carrier is not returning
- Common Carrier
 - Wellborn Forest will not accept responsibility for damage to product shipped by common carrier when this method of shipment is chosen by the customer. We highly discourage this method of shipment.
- UPS
 - Contact UPS to file a claim. Original packaging must be available for inspection by a UPS representative.

Concealed Damage

Product(s) discovered to have sustained concealed damage will be replaced by Wellborn Forest at no additional charge if noted on order form at time order is placed.

The items must be reported to account services within 30 days from the date of delivery and held for inspection and final disposition by a Wellborn Forest Sales Representative.

Credit will not be issued if damage notification exceeds 30 days from the date of invoice. Please be advised that an invoice for the replacement item(s) may be generated if the item(s) is/are not available for inspection.

*All damage replacement items submitted within 30 days from the date of delivery will be produced on the next available Production date at no charge. Exceptions: Items not stocked in inventory.

Defective Materials

Doors

Doors that are warped 1/4" or less must be allowed to hang through two seasons (Ex. Spring to Summer) before a no charge replacement will be considered. Some doors may warp slightly after installation due to high or low humidity levels in the home. The door will usually return to a normal flat position after going through the seasonal change. Please ensure that the door is warped rather than the cabinet being racked or out of square.

Cabinets or Parts

Wellborn Forest will replace, at no charge, up to two cabinets or six doors per kitchen order that are deemed defective. Replacements above this level will be shipped out at a charge and a Return Materials Authorization number will be issued. If upon return, the product is determined to be defective a credit will be issued at that time.

Finish

Complaints concerning stain, or glaze finish must be inspected by a Wellborn Forest Account Representative. Wellborn Forest reserves the option of approving a field repair or returning the product to factory for repair or replacement. Exposure to smoke, water, or extreme sunlight may alter the original appearance. Slight variations in grain and color are not considered defects, as this is the natural character of wood. **Veneered panel doors are not guaranteed to match solid wood framing on the same door in either the raw or finished state. Veneers will absorb stain differently than solid wood. The mismatch of solid and veneers is not considered defective.**

Return Policy

Returns will be handled on a case-by-case basis. Contact account services when an RMA is considered necessary.

Note: The return policy pertains to defective, damaged, warranty, or Wellborn Forest administrative errors only. RMA does not include customer errors.

Items must be returned within 60 days of delivery. Items returned after 60 days will not receive credit. Issuance of RMA does not guarantee issuance of credit. **Returned products not found to agree with claim upon inspection may be returned to the customer. VP of Sales must approve return of items.**



POLICIES & PROCEDURES

Shortages

Wellborn Forest Truck or Contract Carrier

Note the shortage on the shipper and obtain the driver's signature. Fax the signed shipper with a list of the shortage(s) to account services immediately. Shortages will be produced to ship at no charge.

Shortages reported after 10 days will be charged.

We will determine the best method to ship the shorted item(s), including the preferred Cycle Truck. Customers requesting expedited shipment (overnight or second day delivery) of shorted item(s) will be responsible for freight charges. This charge will be invoiced to the customer.

Backorders

Backorders are parts that do not ship with the order and are indicated as such on the packing list. Backorders can and do occur, the result of various reasons including material out of stock and damage or defective parts occurring in process. Backorders are not invoiced until they are shipped, generally within five days of the original shipment.

Placing an Order

Wellborn Forest accepts orders 24 hours a day by fax or by email on the Americana CS order form or a computer design program (2020 Design & ProKitchen).

Account Services Emails & Faxes:

- cvickers@wellbornforest.com / 256.215.3303
- tdenney@wellbornforest.com / 256.215.3325

To Place an Order

1. Orders may be placed using order forms provided (free of charge), or a computer design program form of the following:
 - 2020 Design - fax or email the 2020 manufacturer codes quote report along with a Americana CS order form with specifics as a cover page (***When emailing, export report as a pdf or html file**).
 - Capital Series nomenclature must be used to avoid delays in processing.
2. Specify on each order the **finish, door style, species, hinge preference** (left, right or both), and **drawer box**. ***Please remember when placing an order, only one door style, finish and box style per order!**
3. Specify **shipping method** (truckload, cycle truck, or customer pickup), and **Customer Purchase Order #**.
4. Orders are entered for production on a first entered/first scheduled basis. Orders exceeding our daily capacity will be entered to produce on the next production schedule.

Cut-Off Time

Wellborn Forest ships within a ten (10) working day lead-time schedule. To ensure that your delivery arrives within the lead-time schedule, you may place your order **in advance** or on your **ZONE Cut-off Day**. The cut-off date is actually the **last day** that you may **make changes to** an order.

See chart below for ZONE Cut-off times.

	CUT-OFF DATE	CUT-OFF TIME	SUBMIT CHANGES TO ORDERS BY
ZONE A	Monday	8:00 am CST	Noon
ZONE B	Tuesday	8:00 am CST	Noon
ZONE C	Wednesday	8:00 am CST	Noon
ZONE D	Thursday	8:00 am CST	Noon
ZONE E	Friday	8:00 am CST	Noon

Deadline to submit orders for the next available production schedule is 8:00 am CST on your ZONE Cut-off Date. We recommend that you place your orders in advance to allow adequate time to review your confirmation.

Order Processing

Wellborn Forest enters orders using the nomenclature listed in this Price Catalog.

Itemized order acknowledgements are faxed by 10:00 am on your Cut-off Date. It is the customer's responsibility to check the itemized order confirmation for accuracy and notify account services immediately if a change is necessary. If you do not receive an acknowledgement by 10:00 am, consider that we did not receive the order and contact account services.

Change Order Procedures

Review of orders and changes must be submitted no later than (12:00pm) CST on your cut-off day or no later than 24 hours after receipt of confirmation, depending on which is earliest.

Please be aware that changes to orders between the time you send Wellborn Forest the order and receipt of itemized acknowledgement may result in duplication of order. Changes to orders should be made to the itemized order confirmation to avoid production delays. (If we do not hear from you, we will assume the acknowledgement correctly reflects your cabinet order.) All changes or corrections to orders must be faxed. Changes to orders such as: complete door style, wood species, or finish change will result in cancellation of the order and reorder for the next available production week.

Changes, including cancellations, made to orders after (12:00pm) CST on your Cut-off Date will be subject to a 25% (of the cost of the item) Change Order Processing fee. These changes will delay the production and shipment of the order until the next available production date for your zone.

No changes will be allowed 48 hours after cut-off or on Custom Modification cabinets. All changes or corrections to orders must be faxed.

Cancellations and change requests will not be accepted for any orders received that are tagged WFex. Due to the efforts of our purchasing department to order and receive goods in a short amount of time, we find many times that these orders are already produced, packaged and due to be shipped when cancellation and change requests are made. As a result, we will no longer accept cancellations or changes on those orders.

POLICIES & PROCEDURES



What Zone are you in?

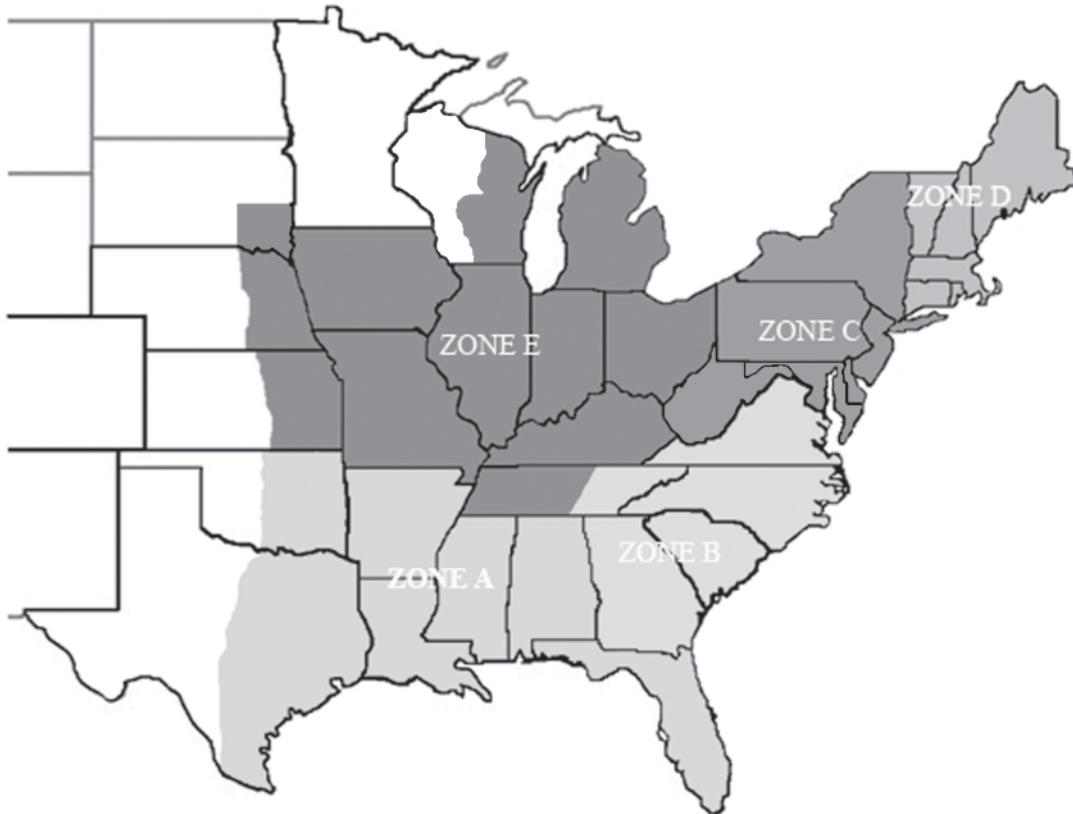

Delivery Zone Schedule

	CUT-OFF DATE	PRODUCTION DATE	DELIVERY START DATE
ZONE A	Wednesday	following Friday	Tuesday
ZONE B	Thursday	following Monday	Wednesday
ZONE C	Friday	following Tuesday	Monday
ZONE D	Monday	following Wednesday	Monday
ZONE E	Tuesday	following Thursday	Monday

Pricing Discrepancy

Wellborn Forest strives to insure all pricing programs are identical to avoid pricing/quoting errors. If a pricing discrepancy exists between (20/20, ProKitchen, Price Quote) and the Price Book, use the current year's price book as the rule unless otherwise informed. If you are in doubt of any pricing, contact your account services representative.



ORDER FORM

Carla Fax: 256-215-3303 • cvickers@wellbornforest.com
 Tracey Fax: 256-215-3325 • tdenney@wellbornforest.com
 Phone: 800-846-2562

Order Date: _____

Page _____ Of _____

OFFICE USE ONLY
 Q CODE

Please do not use this box for shortages, or concealed damage replacements.

WARRANTY SERVICE REQUEST

Original Order # _____

Original P.O. # _____

- Warranty orders require field inspection and a signed authorization from our sales rep
- All defective product replacement orders will be scheduled to produce on the next WFEX date of order placement (excludes purchased doors)
- All orders will be scheduled on a WF truck or UPS
- No changes or cancellations may be made after the order is processed

DAMAGE REPLACEMENT

Original Order #: _____

 No charge if notified within 30 days from invoice date

Must select ship method
 Standard or WFEX

Standard Shipping
 Cycle Truck UPS

OR

WFEX (ADD 20%)
 WF Truck UPS LTL

Alpha Code

PO #

REQUIRED ENTRY

Invoice To: _____
 Street _____
 City _____
 State _____ Zip _____
 Phone _____
 Email _____

Designer Name: _____
 NOTE: No job sites or home deliveries • Use this area only if ship to: is different
 Ship To: _____
 Street _____
 City _____
 State _____ Zip _____

DOOR (SPECIFY DOOR STYLE/SPECIES)

5 PIECE DRAWER FRONT OPTION
 Add \$25 Per Drawer

FINISH FINISH AGREEMENT REQUIRED ON GLAZES, PAINTS

ITEM	QTY	ENDS L/R/B	MODIFICATION DESCRIPTION <small>(ONLY ONE DOOR STYLE, FINISH, AND BOX STYLE PER ORDER)</small>	MOD MARKUP		HINGE L/R/DECO	LIST PRICE	MULTIPLIER APPLIED
				%LIST	\$LIST			

BEFORE ORDERING, PLEASE NOTE

- Order is subject to credit approval
- Must specify finished ends L, R, B
- Specify the blind side on corner cabinets
- Specials must be approved prior to order placement

Truckload Order: Max 2700 Cubic Ft. 48' Trailer/Max 3200 Cubic Ft. 53' Trailer

MKT1002-2016 Authorized Signature:

PRODUCT AWARENESS



The natural hardwoods and hardwood veneers used in Wellborn Forest cabinetry vary in color and grain pattern. Colors may vary from white, to red, to black, and even green, sometimes in the same door or drawer front. Some wood species such as maple have smooth even grain patterns, while oak has a more open and sometimes even wild grain variation. Some wood species display mineral streaks, worm tracks, small knots and pitch pockets. Some woods, particularly cherry and maple, are susceptible to light and the environment, causing the wood tone to mellow and darken over time. These variations are created by nature and are generally acknowledged as the beauty of wood and are not considered a manufacturing defect.

Cabinets And The Environment

By its very nature, wood moves to expand and contract as it absorbs and releases moisture into the environment. As the wood absorbs moisture, the wood grain expands, and conversely, when the wood releases moisture the wood grain contracts or shrinks. The wood will expand and contract disproportionately meaning in unequal directions. The resulting movements can emphasize joints on cabinet doors, drawer fronts and face frames to be more pronounced even though they are a finished product with stain, sealer coat, and top coat applied. Miter joints are more susceptible to open or gap as a result in humidity level fluctuations. In most cases, the wood product will return to normal position if not exposed to extremes of humidity for a prolonged period and maintained in a stable atmospheric environment. These changes are not considered a manufacturing defect.

Humid Environments

Humid environments contain a high amount of moisture in the air. Cabinets exposed to these high humidity levels will absorb excessive moisture and therefore expand or swell. This means that joints, scratches and other imperfections may become more pronounced and visible to the naked eye. If wood products are exposed to humid conditions for a prolonged period of time, they may not return to their normal condition once the atmospheric conditions become more stable.

Arid Environments

Arid or dry climates can also result in wood movement. The moisture in the wood product has been absorbed by the environment causing the wood to dry. Shrinkage of wood can cause joints to open and become more pronounced and magnify any scratches and other imperfections even though the product has a stain, sealer coat, and top coat applied. Wood products exposed to arid environments for a shortened period of time may regain moisture and return to their normal condition in the appropriate atmospheric conditions.

Climate Equilibrium

Proper steps can insure an appropriate climate for your Wellborn Forest cabinetry.

- Minimize exposure to sunlight, smoke, and household cleaners.
- Maintain the appropriate climate control systems within the home or storage areas to reduce the occurrence of moisture related issues. It is recommended to maintain the temperature in your home within a range of 60 - 90°F.
- Cabinetry should not be too close or directly facing air vents or radiant heat sources.
- Choose the appropriate wood species for your area. Remember solid wood is created from a single piece of wood. Engineered wood is made from several layers of wood and is designed to withstand higher levels of humidity.

Your cabinetry will perform and look beautiful for many years by following these suggestions to maintain a stable atmosphere. The warranty does not cover damage from exposure to extreme fluctuations in humidity levels or temperature or product concerns related to improper control of humidity or moisture levels.

Group A

Concord Maple

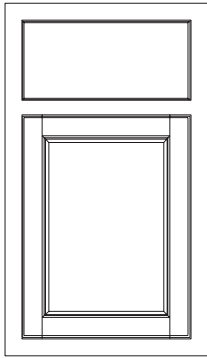

- 1/2 inch overlay
- 2 inch solid maple stiles and rails; 3/4 inch thick
- 3/16 inch maple plywood panel
- Mortise & tenon construction
- Concealed hinge
- Solid maple drawer front matches door edge profile

Franklin Maple

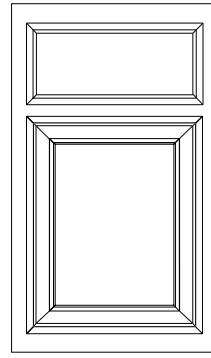

- 1/2 inch overlay
- 2 inch solid maple stiles and rails; 3/4 inch thick
- 3/16 inch maple plywood panel
- Mitered corners
- Reverse bevel edge profile with a two step profile
- Concealed hinge
- Solid maple drawer front matches door edge profile

Group B

Concord Raised Panel Maple

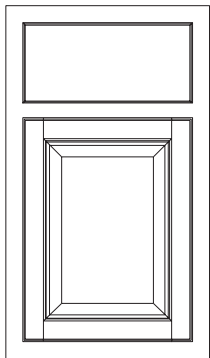

- 1/2 inch overlay
- 2 inch solid maple stiles and rails; 3/4 inch thick
- 7/16 inch veneer raised center panel
- Mortise & tenon construction
- Concealed hinge
- Solid maple drawer front matches door edge profile

Franklin Raised Panel Maple

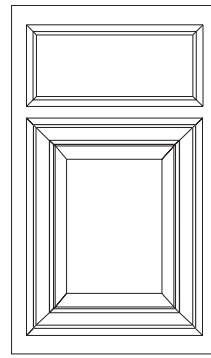

- 1/2 inch overlay
- 2 inch solid maple stiles and rails; 3/4 inch thick
- 7/16 veneer raised center panel
- Mitered corners
- Reverse bevel edge profile with a two step profile
- Concealed hinge
- Solid maple drawer front matches door edge profile

Dover Maple

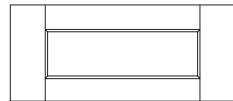
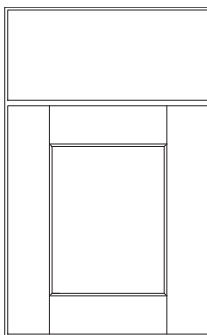

5 Piece Drawer Front Option
\$25 List Per Drawer Upcharge

- 1 9/16 inch overlay
- 2 3/4 inch solid maple stiles and rails; 3/4 inch thick
- 3/16 inch maple plywood panel
- Mortise & tenon construction
- Concealed hinge
- Solid maple drawer front matches door edge profile

DOOR STYLES



Group C

Albany Maple

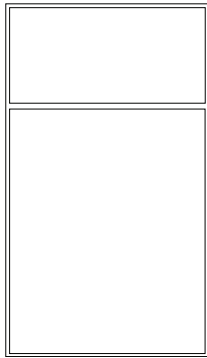

- 1-9/16 inch overlay
- 3/4 inch maple hardwood veneer
- Door and drawer front are edgebanded
- Concealed hinge
- **Prep For Glass (PFG) not available**

Group D

Atlanta Maple

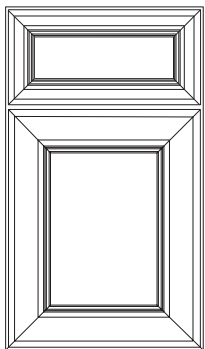

- 1 9/16 inch overlay
- 2 3/4 inch solid maple stiles and rails; 3/4 inch thick
- 3/16 inch maple plywood panel
- Mitered corners
- Concealed hinge
- 5 piece drawer front with flat center panel

Lawrence Maple

NEW

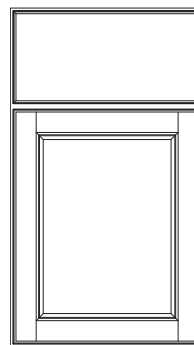

- 1 9/16 inch overlay
- 2 inch solid maple stiles and rails; 3/4 inch thick
- 3/16 inch maple plywood panel
- Mortise & tenon construction
- Reverse bevel edge profile with a two step profile
- Concealed hinge
- Solid maple drawer front matches door edge profile

Group E

Atlanta Raised Panel Maple

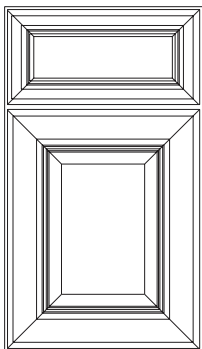

- 1 9/16 inch overlay
- 2 3/4 inch solid maple stiles and rails; 3/4 inch thick
- 7/16 inch veneer raised center panel
- Mitered corners
- Concealed hinge
- 5 piece drawer front with flat center panel

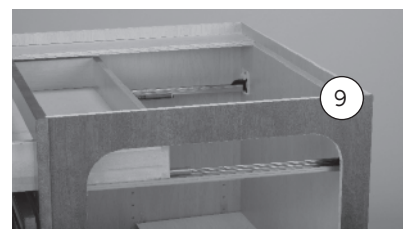
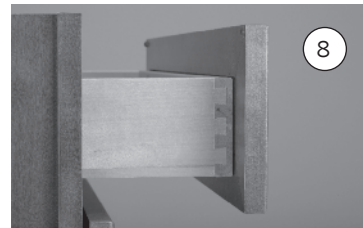
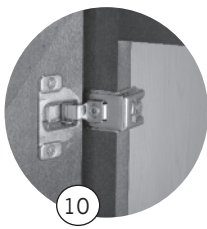

See page 11 for cabinet specifications

CABINET SPECIFICATIONS



① FACE FRAMES	3/4" x 1 3/4" kiln dried maple stiles & rails, joined with wood screws.
② END PANELS	1/2" hardwood veneer with UV clear coat interior. Exterior veneer matches face frame wood species and is finished to match when finished end is specified.
③ TOPS & BOTTOMS	1/2" hardwood veneer with UV clear coat interior.
④ I-BEAM RAILS	1/2" plywood dadoed, glued & stapled into face frame and end panels & then stapled to back panel.
⑤ SHELVES	Adjustable, 3/4" hardwood veneer with UV clear coat, front edge is maple edgebanded. Base cabinet shelves are 1/2 depth of cabinet.
⑥ BACKS	3/16" hardwood veneer with UV clear coat.
⑦ TOE SPACE	1/2" x 4 1/2" plywood on base cabinets.
⑧ DRAWER BOX	Full length, four-sided, 5/8" solid wood with 3/16" plywood bottom grooved into four sides. Dovetail joinery on four sides.
⑨ DRAWER GUIDES	Soft-close full access drawer guide: <ul style="list-style-type: none"> • 75 pound load capacity • Full-access – 7/8 extension, soft-closing feature • Strong, resilient tracks and precision steel ball bearings • Installed with plug-in, adjustable rear brackets for positive placement and stability. • Tool-free height adjustment • Made in the USA • Lifetime Warranty
⑩ HINGES	6-Way adjustable, concealed cup hinge, 110 degree opening. Lifetime Warranty.



Stains

Ginger: Mid-tone golden brown stain **NEW**

Hazelnut: Warm dark sepia brown stain **NEW**

Honey: Light golden brown stain that blends heartwood and sapwood

Java: A once applied dark brown to black stain

Nutmeg: Dark brown stain

Rose': Reddish brown stain

Paints - 10% Upcharge

Signed Finish Agreement Required

These color paint finishes are available without glazing. Paint finishes are applied on hardwood or hardwood veneer products. Due to our finishing process, some wear-through or sand-through may occur on the sharper edge profiles of doors and drawer fronts. This is not considered a manufacturing defect.

Please note that wood naturally expands and contracts with seasonal changes in temperature and humidity. As wood moves at joints, this movement will be more apparent with painted finishes than stained finishes and will look like a small fracture or seam at the joint. The joints on mitered door styles may be more noticeable than mortise & tenon construction. These characteristics are inherent and will not be considered defective.

For homeowners concerned about day-to-day mishaps in high activity kitchens or baths, Wellborn Forest Products does not recommend Paint finishes due to the finish application process.

Paints

Arctic: White painted finish

Champagne: Soft beige painted finish

Glazes - 20% Upcharge

Signed Finish Agreement Required

Refer to the Finish Availability Chart for door style and finish availability

Glazing is a finishing process where a base stain or paint is applied to the wood for consistent color coverage. A flood coat of glaze is then applied and hand-wiped to create hang-up of varying tones from light to dark in the detail areas (corners, door grooves, profiles, and woodgrains) of the door or drawer front. Glazing hang-up is uneven and inconsistent creating a unique look that mimics antique, old world finishes. **Certain doors and drawer fronts may not be conducive for glazing due to less detailing of the profiles.** A veneer center panel absorbs more of the glaze resulting in a slightly darker color than on the solid wood components of the door frame.

The amount of hang-up will vary by wood species, by door profile, by stain or paint and glaze color, and especially by how much glaze is removed from the product. The variation must be judged for its overall effect in the entire finished installation and not in one single door or cabinet. Again, this is a hand-wiped process and due to its lack of automation or standardization, the glazed finish will vary from piece to piece, door to door, cabinet to cabinet, and job to job.

Glazes

Chocolate: Dark brown glaze

Shadow: Black glaze

FINISHES



Finish Chart

FINISH	% Upcharge	Albany	Atlanta	Atlanta Raised Panel	Concord	Concord Raised Panel	Dover	Franklin	Franklin Raised Panel	Lawrence
Hazelnut		•	•	•	•	•	•	•	•	•
Honey		•	•	•	•	•	•	•	•	•
Ginger		•	•	•	•	•	•	•	•	•
Nutmeg		•	•	•	•	•	•	•	•	•
Rose'		•	•	•	•	•	•	•	•	•
Java		•	•	•	•	•	•	•	•	•
Ginger Chocolate	20%		•	•	•	•	•	•	•	•
Ginger Shadow	20%		•	•	•	•	•	•	•	•
Hazelnut Shadow	20%		•	•	•	•	•	•	•	•
Honey Chocolate	20%		•	•	•	•	•	•	•	•
Honey Shadow	20%		•	•	•	•	•	•	•	•
Nutmeg Chocolate	20%		•	•	•	•	•	•	•	•
Nutmeg Shadow	20%		•	•	•	•	•	•	•	•
Rose' Shadow	20%		•	•	•	•	•	•	•	•
Champagne	10%		•	•	•	•	•	•	•	•
Arctic	10%		•	•	•	•	•	•	•	•
Champagne Chocolate	20%		•	•	•	•	•	•	•	•
Arctic Chocolate	20%		•	•	•	•	•	•	•	•

• Available Finish

Upcharge for Paints & Glaze Finishes



Glazes and Paints Finishes

I understand that the variation in pattern and color visible in Glaze or Paint finished cabinetry is an element in the beauty of the wood and artistry, not a defect. As the cabinetry goes through the finish process, the color of each component is matched as closely as possible. Variations in the wood are emphasized in certain finishes, such as Glazes finishes. No attempt is made by craftsmen to tone down or cover up these color variations present in the wood.

I also understand that when medium or dark finishes are applied to maple, there is the potential for exaggerated light and dark effects, blotchiness and or mottling. Soft spots in the wood and end-grain surfaces will also accept these finishes, predictably darker.

For glaze finishes, since glaze detailing is hand applied then hand wiped off, glaze may hang-up or remain in any corners of the door or drawer profile. Because the glaze is an hand applied procedure, detailing can differ from piece to piece. Due to our finishing process, some wear-through or sand-through may occur on the sharper edge profiles of doors and drawer fronts. This is not considered a manufacturing defect. These potential variations are natural occurrences and are within the standards established by Wellborn Forest Products in their finishing process.

Veneered panel doors are not guaranteed to match solid wood framing on the same door in either the raw or finished state. Veneers will absorb more of the stain and glaze resulting in a slightly darker color than the solid wood components of the door frame. The mismatch of solid and veneers is not considered defective.

Wellborn Forest Products offers several types of painted finishes on cabinetry. Painted finishes are exceedingly different from the standard stained finish. Since normal movement is typical in wood products, certain climatic conditions can cause finish breaks, recesses, and joint and panel lines. Joint separation can be more visible on mitered doors. Joint lines and variations are common attributes of painted finishes and will not be considered sufficient reasons for product replacement. Joint Lines: Expansion and contraction in doors and face frames can cause visible lines at the joints. The finish will still protect the surface and the structural integrity of the joint will not be affected. An open joint line is not considered a defect.

I find the uniqueness of those variations desirable and agree not to hold Wellborn Forest Products, nor my Americana Capital Series dealer (whose name appears below) responsible in the event that I find those variations to be less than desirable than I had expected.

For further explanation of finish and wood species variation, refer to the Finish Selections.

The following finishes require a signed Finish Agreement:

Glazes on Stain

Paints

Glazes on Paint

Fill in the finish of your order: _____

Consumer Signature

Date

Consumer Name (please print)

Dealer Signature & Company
(Please Print Company Name and P.O. Number for Reference)

Date

Dealer Name/City/State (please print)

Dealer P.O. Number



CABINET CARE AND CLEANING



Wellborn Forest Products meet or exceed Kitchen Cabinet Manufacturer Association (KCMA) standards for resistance to stains and surface damage that can be caused by common household chemicals. The finish protects the wood and enhances its natural beauty. Please follow these simple special care and maintenance guidelines which will allow you to enjoy your cabinets for many years to come.

Cabinet Interiors

- Wipe with a clean, soft, damp cloth and dry immediately. Never use kitchen cloths or sponges that might have detergent or grease on them, or embedded abrasives.
- To remove food residue or grease, use any common dish washing liquid (not detergent) or solution of mild soap and water. Wipe with a clean damp cloth. Dry thoroughly. If a spill occurs, clean and dry immediately. Left unattended, a spill can soak through the laminate or wood surface and cause damage.

Cabinet Exteriors, Stained and Painted

Your cabinets have been finished with a coating that exhibits excellent resistance to foods, beverages and household agents typically found in the kitchen or bath. However, from time to time, your cabinets will need regular cleaning and care.

- Clean at least once a month to protect the wood by wiping the surface with a clean, damp cloth, then dry immediately. Do not use a dishcloth for cleaning. It could contain remnants of grease or detergents. **Never use soap pads, steel wool, or cleaners that contain bleach, ammonia or abrasives.** These agents may cause discoloration, marring or dulling of the finish. Do not wax or polish cabinet surfaces. Wax build-up will leave a residue that is difficult to remove. Polishes containing silicone should not be used. Products such as Murphy's Oil Soap contain no wax, petroleum or silicones.
- Excess moisture can damage any cabinet finish. Areas near the sink, range, dishwasher, oven and baseboards are most susceptible. With all cabinets, take a little extra care on bottom edges of base cabinets and base cabinet doors where invisible moisture often collects. Keep these surfaces dry.
- Avoid draping damp cloths or dish towels over the cabinet doors. Over a period of time, this moisture could cause permanent damage to your cabinet finish.

Cabinet Environment

- Routine cleaning will help prevent long term damage from smoke and grease. They should be avoided because they can form a hard film over time, dulling the finish.
- When possible, keep cabinets out of direct sunlight or close curtains during the sunniest part of the day. Direct sunlight will cause cabinets to lighten or darken over time.
- Try to avoid exposing your cabinets to very hot and cold environments. Extremes in temperature and moisture can cause wood to expand and contract, eventually damaging the finish.

When ordering a cabinet with a custom modification, please specify custom modification code on order form. Each modification will be priced accordingly. Requests for non-published modifications may be treated as a Custom Order which will require feasibility, pricing and leadtime review and approval. Please check with your account services representative before placing your order.

Modification Option Code	Application	Description/Limitations	Pricing		
			WALL	BASE	TALL
Finished Interior FIN	Most cabinets	<ul style="list-style-type: none"> • Finishes the interior and end panels of the cabinet. • Interior stained to match exterior; matching wood species. • Finished interior cabinets and mullion door cabinets are bored for shelf clips. 	WALL	BASE	TALL
			250	375	695

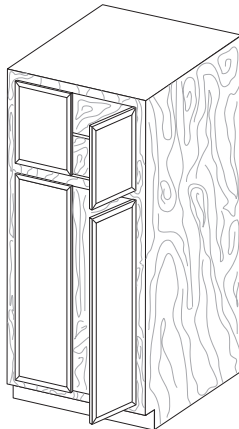

Tall cabinets

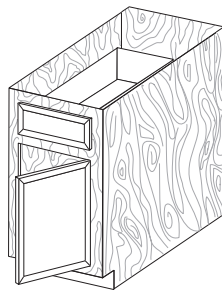

Base cabinets

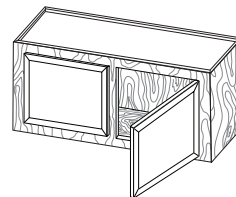

Wall cabinets

Finished Ends	Most cabinets with sides	<ul style="list-style-type: none"> • Must specify finished ends left, right, or both • Creates a matching finished veneer plywood exterior with UV clear coat interior. • Finished ends same species as face frame • Finished ends are standard on finished interior cabinets 	WALL	BASE	TALL
			20	40	60

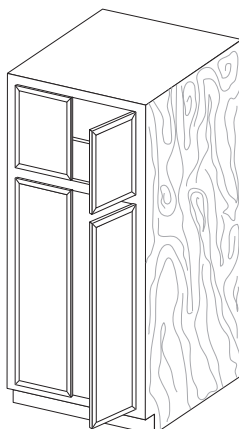

Tall cabinets

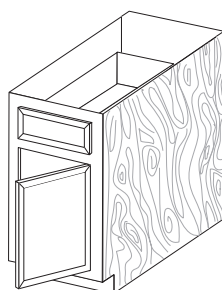

Base cabinets

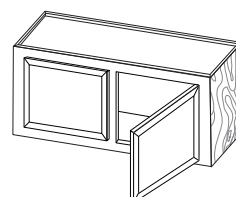

Wall cabinets

CUSTOM MODIFICATIONS



Modification Option Code	Application	Description/Limitations	Pricing	
Increase Depth DP	Most wall cabinets	<ul style="list-style-type: none"> Increases the depth of a wall cabinet in 1" increments to a maximum depth of 27". To order, use actual size (ex. 18DP) Available on wall cabinets with drawers in 3" increment, up to 24". Not available on the following cabinets: DC, DS, DWEP, SCW, WR 	WALL	
			225	
	Most base, tall, vanity cabinets	<ul style="list-style-type: none"> Increases the depth of a base, tall and vanity and office cabinet in 3" increments to a maximum depth of 30". When depth beyond 24" is desired, base cabinet will have drawer blanks, no drawers. To order, use actual size (ex. 18DP) Not available on the following cabinets: BLS, BWPS, CS, CSB, DCS, DCSB, OBL, PBWN, RWPS, SSB, SSK, SWB, TC18, UACSB, UADCSB, USK, UASSB, UATC15, VSSK, VUSK 	BASE	TALL
350			575	
End Panels and Skins	<ul style="list-style-type: none"> MBEP, MWEP, MTEP, MVEP, MVEPT, OMEP, BEP, REP, UAMBEP, WEP depth can only be increased 3" increments. Skins can be increased in 1" increments. 	50% Upcharge		

Modification Option Code	Application	Description/Limitations	Pricing	
Decrease Depth DP	Most wall cabinets	<ul style="list-style-type: none"> Reduces the depth of a wall cabinet in 1" increments to a minimum depth of 6". To order, use actual size (ex. 18DP) Not available on the following cabinets: DC, DS, DWEP, SCW, WR 	WALL	
			195	
	Most base, tall and vanity cabinets	<ul style="list-style-type: none"> Reduces the depth of a base, tall, and vanity cabinet in 3" increments. Reduce to 21", 18" and 15" only. When depth less 15" is desired, base cabinet will have drawer blanks, no drawers. Undermount full extension guides available for 15", 18", & 21" deep cabinets with dovetail only To order, use actual size (ex. 18DP) Not available on the following cabinets: BLS, BWPS, CS, CSB, DCS, DCSB, OBL, PBWN, RWPS, SSB, SSK, SWB, TC18, UACSB, UADCSB, USK, UASSB, UATC15, VSSK, VUSK 	BASE	TALL
295			450	
End Panels and Skins	<ul style="list-style-type: none"> Matching Wall End Panel depth can only be reduced 3" increments. Pilasters and skins can be reduced in 1" increments. 	50% Upcharge		

When ordering a cabinet with a custom modification, please specify custom modification code on order form. Each modification will be priced accordingly. Requests for non-published modifications may be treated as a Custom Order which will require feasibility, pricing and leadtime review and approval. Please check with your account services representative before placing your order.

Modification Option Code	Application	Description/Limitations	Pricing
Full Height Door FHD	Base & vanity cabinets only	<ul style="list-style-type: none"> This option is designed to replace a drawer & door combination with a full height door 	No Upcharge

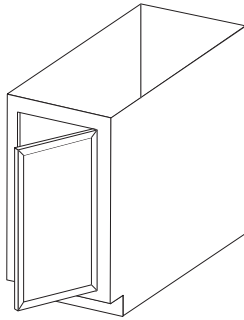

Prep For Glass PFG	Most cabinets	<ul style="list-style-type: none"> Back side of door routed to accept 1/8" glass Glass not included Specify finished interior PFG-Bottom Not Available for Utility cabinets Prep For Glass not available for Albany 	95 Per Door
---------------------------	---------------	--	----------------

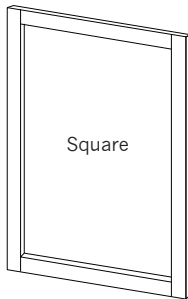

NOTES





Item Description	A	B	C	D	E
Concord Maple Franklin Maple					
Concord RP Maple Dover Maple Franklin RP Maple					
Albany Maple					
Lawrence Maple Atlanta Maple					
Atlanta RP Maple					

12" High Wall

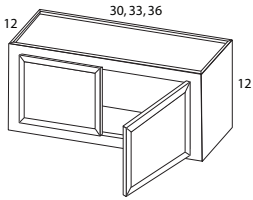

3012	193	214	219	221	272
3312	209	229	234	237	290
3612	219	242	247	250	309

- No shelf
- Butt doors

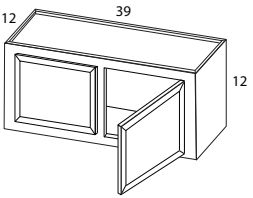

3912	240	264	270	273	334
------	-----	-----	-----	-----	-----

- No shelf

15" High Wall

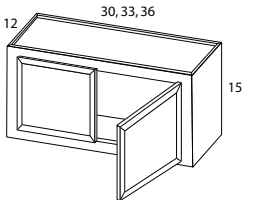

3015	240	256	262	266	309
3315	252	272	278	282	327
3615	262	284	290	294	343

- No shelf
- Butt doors

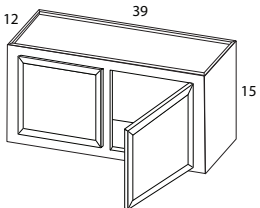

3915	272	292	298	303	351
------	-----	-----	-----	-----	-----

- No shelf



Item Description	A	B	C	D	E
Concord Maple Franklin Maple					
Concord RP Maple Dover Maple Franklin RP Maple					
Albany Maple					
Lawrence Maple Atlanta Maple					
Atlanta RP Maple					

18" High Wall

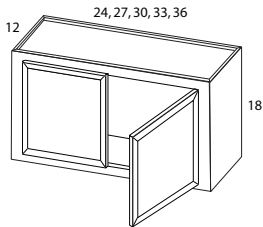

2418	253	273	279	283	325
2718	258	278	284	288	332
3018	266	285	291	295	340
3318	279	301	308	313	360
3618	295	317	324	328	383

- No shelf
- Butt doors

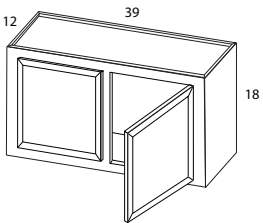

3918	312	335	342	346	398
------	-----	-----	-----	-----	-----

- No shelf

21" High Wall

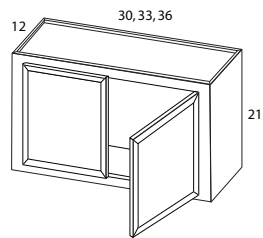

3021	279	299	305	310	357
3321	292	315	322	325	375
3621	307	330	337	341	397

- No shelf
- Butt doors

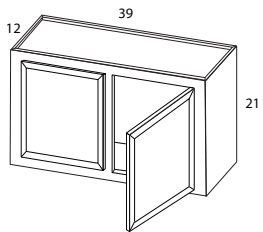

3921	337	361	369	375	433
------	-----	-----	-----	-----	-----

- No shelf



Item Description	A	B	C	D	E
Concord Maple Franklin Maple		Concord RP Maple Dover Maple Franklin RP Maple	Albany Maple	Lawrence Maple Atlanta Maple	Atlanta RP Maple

24" High Wall

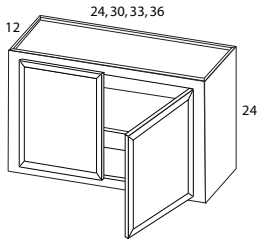

2424	292	314	321	325	376
3024	297	321	328	331	382
3324	316	340	347	351	408
3624	326	352	360	365	422

- 1 Adj. full depth shelf
- Butt doors

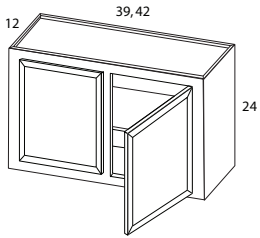

3924	338	364	372	377	435
4224	348	376	384	388	450

- 1 Adj. full depth shelf

27" High Wall

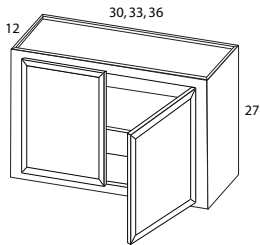

3027	317	340	347	352	408
3327	338	364	372	377	437
3627	352	379	387	392	453

- 1 Adj. full depth shelf
- Butt doors

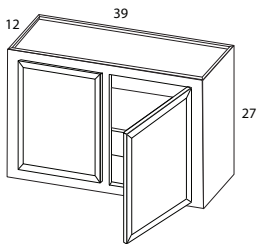

3927	367	395	403	408	471
------	-----	-----	-----	-----	-----

- 1 Adj. full depth shelf



Item Description	A	B	C	D	E
Concord Maple Franklin Maple					
Concord RP Maple Dover Maple Franklin RP Maple					
Albany Maple					
Lawrence Maple Atlanta Maple					
Atlanta RP Maple					

30" High Wall

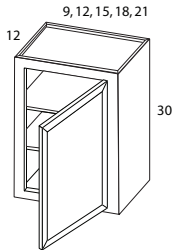

930	182	199	203	216	238
1230	198	213	218	221	257
1530	217	231	236	240	279
1830	243	263	269	272	315
2130	290	314	321	325	377

- 2 Adj. full depth shelves
- Specify L/R hinge

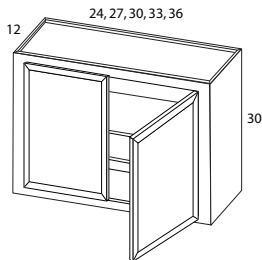

2430	322	349	356	362	422
2730	329	355	363	368	428
3030	336	361	369	375	438
3330	358	383	391	396	464
3630	374	402	411	417	487

- 2 Adj. full depth shelves
- Butt doors

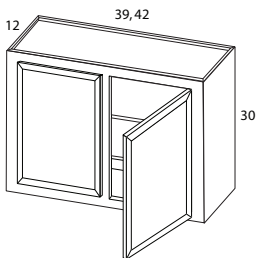

3930	395	425	434	440	509
4230	412	445	454	461	539

- 2 Adj. full depth shelves

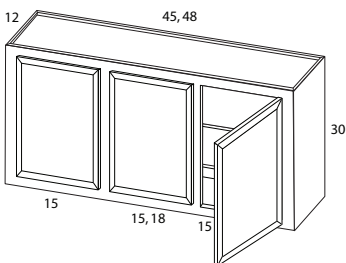

4530	478	515	526	534	615
4830	493	532	543	550	640

- 2 Adj. full depth shelves
- Doors hinged L, R, R



Item Description	A	B	C	D	E
Concord Maple Franklin Maple		Concord RP Maple Dover Maple Franklin RP Maple	Albany Maple	Lawrence Maple Atlanta Maple	Atlanta RP Maple

36" High Wall

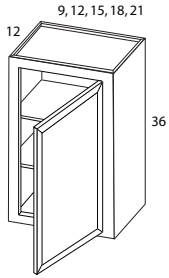

936	231	249	254	258	299
1236	245	264	270	273	315
1536	266	285	291	295	340
1836	294	315	322	325	376
2136	355	381	389	394	457

- 2 Adj. full depth shelves
- Specify L/R hinge

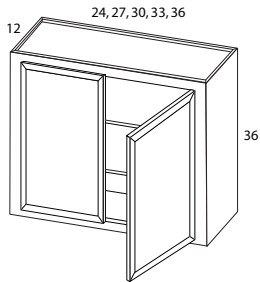

2436	359	389	397	402	468
2736	370	398	406	413	476
3036	391	422	431	437	506
3336	412	448	457	464	534
3636	438	473	483	489	565

- 2 Adj. full depth shelves
- Butt doors

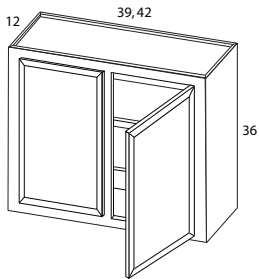

3936	464	497	507	515	596
4236	486	523	534	540	625

- 2 Adj. full depth shelves



Item Description	A	B	C	D	E
Concord Maple Franklin Maple					
Concord RP Maple Dover Maple Franklin RP Maple					
Albany Maple					
Lawrence Maple Atlanta Maple					
Atlanta RP Maple					

42" High Wall

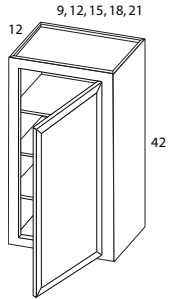

942	324	346	353	359	414
1242	332	359	367	372	431
1542	359	387	395	400	463
1842	377	404	413	419	486
2142	405	436	445	451	520

- 3 Adj. full depth shelves
- Specify L/R hinge

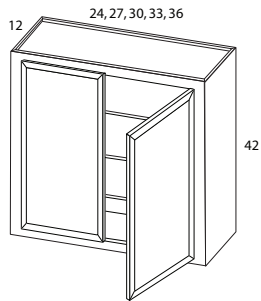

2442	503	541	552	560	648
2742	509	548	559	568	658
3042	548	592	604	612	708
3342	580	626	639	648	745
3642	616	665	679	689	793

- 3 Adj. full depth shelves
- Butt doors

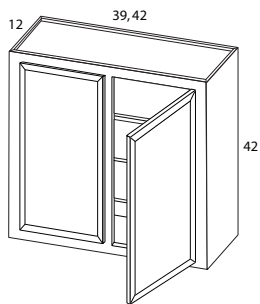

3942	647	684	698	708	818
4242	677	703	718	728	842

- 3 Adj. full depth shelves



Item Description	A	B	C	D	E
Concord Maple Franklin Maple					
Concord RP Maple Dover Maple Franklin RP Maple					
Albany Maple					
Lawrence Maple Atlanta Maple					
Atlanta RP Maple					

12" High Refrigerator Wall

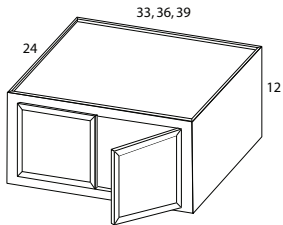

RW3312	265	291	297	301	368
RW3612	278	307	314	318	392
RW3912	305	335	342	347	424

- No shelf
- 33" - 36" Wide cabinets have butt doors
- 39" Wide will have center mullion

18" High Refrigerator Wall

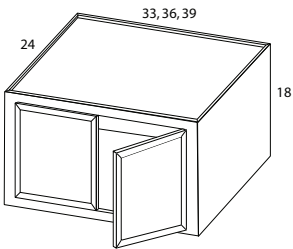

RW3318	354	383	391	398	457
RW3618	374	402	411	417	486
RW3918	397	425	434	439	505

- No shelf
- 33" - 36" Wide cabinets have butt doors
- 39" Wide will have center mullion

24" High Refrigerator Wall

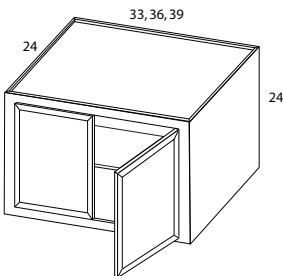

RW3324	401	432	441	446	518
RW3624	414	447	456	464	536
RW3924	429	463	473	479	552

- 1 adj. full depth shelf
- 33" - 36" Wide cabinets have butt doors
- 39" Wide will have center mullion

NOTE: Refrigerator Wall cabinets can not be installed independently. These require additional support by fastening to adjacent cabinet, soffit or end panels



Item Description	A	B	C	D	E
Concord Maple Franklin Maple	Concord RP Maple Dover Maple Franklin RP Maple	Albany Maple	Lawrence Maple Atlanta Maple	Atlanta RP Maple	

Diagonal Corner Wall

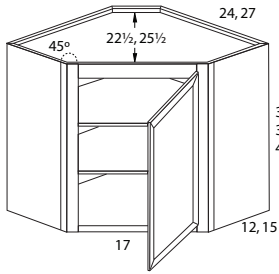

DC2430	342	368	376	382	471
DC2436	411	443	452	458	539
DC2442	543	583	595	603	696
DC2730	514	554	566	620	657
DC2736	618	666	680	721	756
DC2742	817	879	897	956	1001

- 30" & 36" High: 2 adj. full depth shelves
- 42" High: 3 adj. full depth shelves
- **DC27s have finished ends**

Diagonal Corner Susan Wall

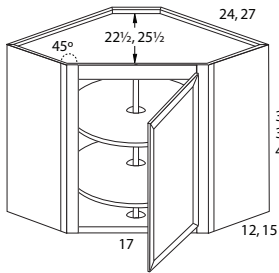

DS2430	431	463	473	480	596
DS2436	519	558	570	579	680
DS2442	638	687	701	711	853
DS2730	648	702	717	769	838
DS2736	779	840	857	913	957
DS2742	961	1034	1055	1124	1177

- 30" & 36" High: (2) · 18" Diameter rotating shelves and pole shipped installed
- 42" High: (3) · 18" Diameter rotating shelves and pole shipped installed
- **DS27s have finished ends**



Item Description	A	B	C	D	E
Concord Maple Franklin Maple					
Concord RP Maple Dover Maple Franklin RP Maple					
Albany Maple					
Lawrence Maple Atlanta Maple					
Atlanta RP Maple					

Microwave Wall

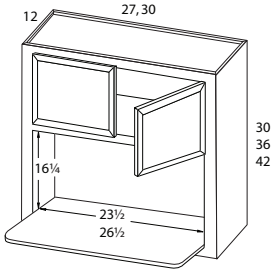

MW2730	804	825	842	896	942
MW2736	923	949	968	1034	1081
MW2742	985	1016	1037	1104	1156
MW3030	812	842	859	910	964
MW3036	979	1010	1031	1098	1150
MW3042	1062	1097	1119	1193	1248

- 3/4" Thick shelf
- 17" Deep plywood shelf shipped loose
- Butt doors
- Plywood construction
- Finished interior

Universal Microwave Wall

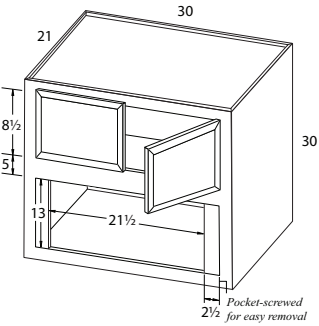

UMW3030	1015	1052	1074	1137	1207
UMW3036	1224	1262	1288	1370	1437
UMW3042	1329	1371	1399	1491	1561

- Butt doors
- Plywood construction
- Finished interior
- Floor is flush with top of rail

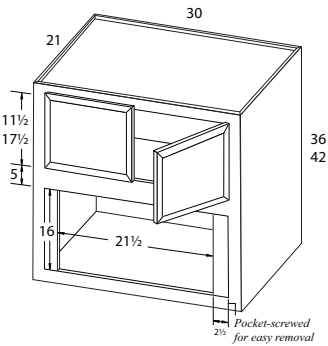



Item Description	A	B	C	D	E
	Concord Maple Franklin Maple	Concord RP Maple Dover Maple Franklin RP Maple	Albany Maple	Lawrence Maple Atlanta Maple	Atlanta RP Maple

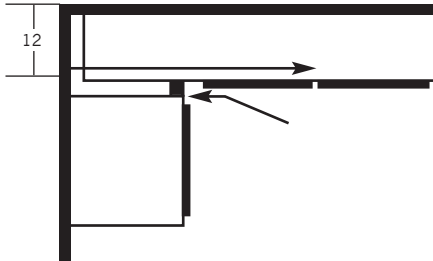

When installing with hardware:
 On all 1/2" overlay door styles, cabinet must be pulled 1 1/4" & use a 1 1/4" filler with the adjoining cabinet to obtain a 90° clearance.
 On all 1 9/16" overlay door styles, cabinet must be pulled 2 1/4" & use a 2 1/4" filler with the adjoining cabinet to obtain a 90° clearance.

WALL SPACE

UNIT	MIN	MAX	ACTUAL CASE SIZE
C24	24"	28 ³ / ₄ "	24"
C30	30"	34 ³ / ₄ "	30"
C36	36"	40 ³ / ₄ "	36"
C42	42"	46 ³ / ₄ "	42"
C48	48"	52 ³ / ₄ "	48"

WALL CABINETS

Blind Corner Wall, 30" High

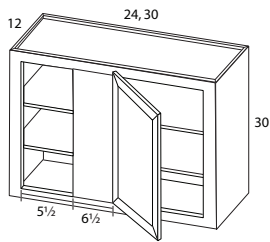

C2430	229	243	248	251	289
C3030	302	323	330	334	388

- 2 Adj. full depth shelves
- Door hinged to mullion
- Specify blind L/R

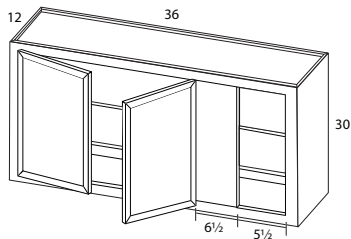

C3630	352	377	385	390	455
-------	-----	-----	-----	-----	-----

- 2 Adj. full depth shelves
- Butt doors
- Specify blind L/R

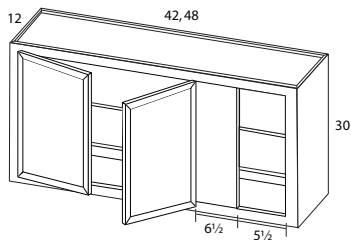

C4230	359	383	391	396	464
C4830	390	417	426	432	498

- 2 Adj. full depth shelves
- Butt doors
- Specify blind L/R



Item Description	A	B	C	D	E
Concord Maple Franklin Maple		Concord RP Maple Dover Maple Franklin RP Maple	Albany Maple	Lawrence Maple Atlanta Maple	Atlanta RP Maple

Blind Corner Wall, 36" High

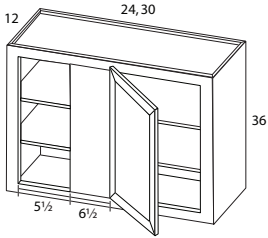

C2436	298	317	324	327	380
C3036	314	334	341	346	397

- 2 Adj. full depth shelves
- Door hinged to mullion
- Specify blind L/R

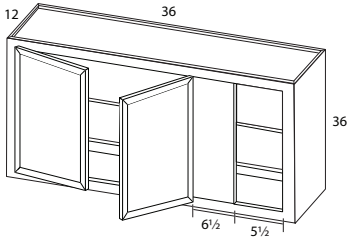

C3636	359	383	391	396	458
-------	-----	-----	-----	-----	-----

- 2 Adj. full depth shelves
- Butt doors
- Specify blind L/R

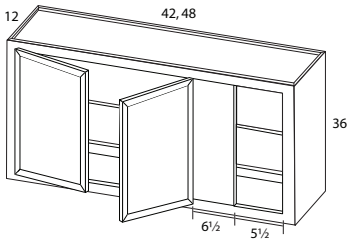

C4236	370	395	403	408	471
C4836	453	484	494	501	578

- 2 Adj. full depth shelves
- Butt doors
- Specify blind L/R



Item Description	A	B	C	D	E
Concord Maple Franklin Maple					
Concord RP Maple Dover Maple Franklin RP Maple					
Albany Maple					
Lawrence Maple Atlanta Maple					
Atlanta RP Maple					

Blind Corner Wall, 42" High

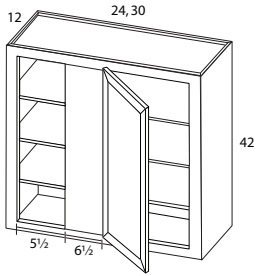

C2442	347	370	378	383	440
C3042	364	388	396	401	461

- 3 Adj. full depth shelves
- Door hinged to mullion
- Specify blind L/R

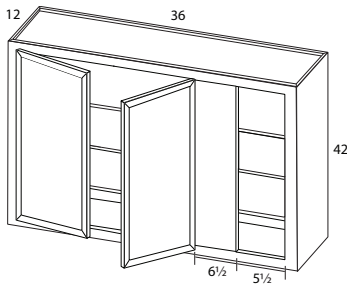

C3642	396	423	432	438	507
-------	-----	-----	-----	-----	-----

- 3 Adj. full depth shelves
- Butt doors
- Specify blind L/R

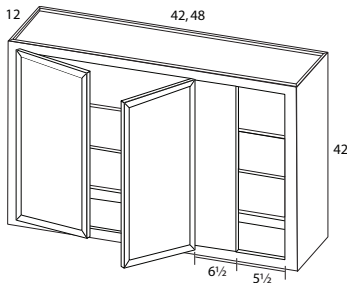

C4242	412	443	452	458	530
C4842	550	590	602	610	702

- 3 Adj. full depth shelves
- Butt doors
- Specify blind L/R

Square Corner Wall

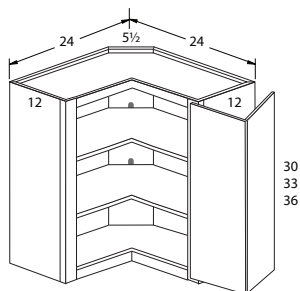

SCW2430	659	711	726	774	809
SCW2436	782	844	861	916	958
SCW2442	906	978	998	1062	1113

- 30" & 36" High: 2 adj. full depth shelves
- 42" High: 3 adj. full depth shelves
- Finished ends
- Depth modifications not available



Item Description	A	B	C	D	E
Concord Maple Franklin Maple					
Concord RP Maple Dover Maple Franklin RP Maple					
Albany Maple					
Lawrence Maple Atlanta Maple					
Atlanta RP Maple					

Peninsula Wall Cabinet, 18" High

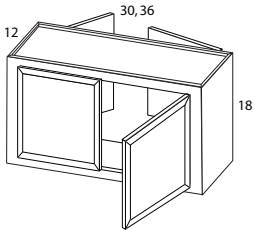

PW3018	491	527	538	545	633
PW3618	506	547	558	567	657

- No shelf
- Butt doors

Peninsula Wall Cabinet, 24" High

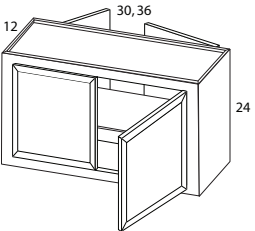

PW3024	557	599	611	621	718
PW3624	573	616	629	639	737

- 1 Adj. full depth shelf
- Butt doors

Peninsula Wall Cabinet, 30" High

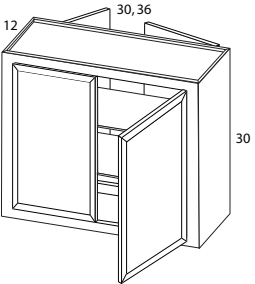

PW3030	598	647	660	670	774
PW3630	668	720	735	745	862

- 2 Adj. full depth shelves
- Butt doors



Item Description	A	B	C	D	E
Concord Maple Franklin Maple		Concord RP Maple Dover Maple Franklin RP Maple	Albany Maple	Lawrence Maple Atlanta Maple	Atlanta RP Maple

Matching Wall End Panel

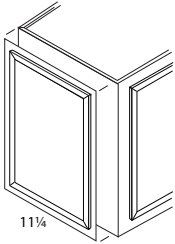

MWEP30	126	133	136	138	160
MWEP36	147	159	163	164	188
MWEP42	173	185	189	191	220

- 3/16" Panel
- Panel & door shipped loose

Door Dimensions

	1/2" Overlay	1 9/16" Overlay
30	11" W x 27-1/2" H	11-5/8" W x 29-5/8" H
36	11" W x 33-1/2" H	11-5/8" W x 35-5/8" H
42	11" W x 39-1/2" H	11-5/8" W x 41-5/8" H

WALL CABINETS



Item Description	A	B	C	D	E
Concord Maple Franklin Maple					
Concord RP Maple Dover Maple Franklin RP Maple					
Albany Maple					
Lawrence Maple Atlanta Maple					
Atlanta RP Maple					

Wall Accessories

Canopy Wood Hood

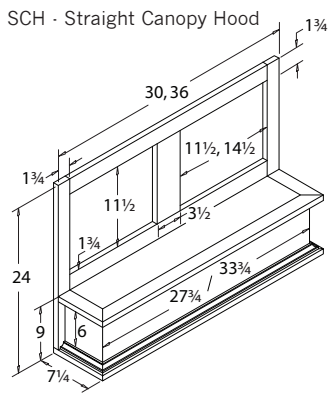
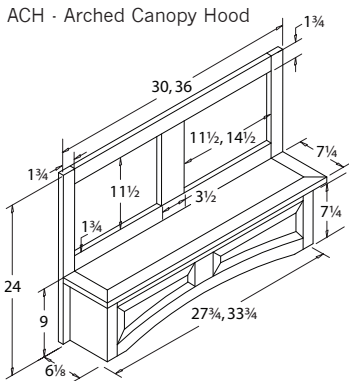

ACH3024	2662	2882	2940	2950	3007
ACH3624	2923	3187	3251	3280	3337
SCH3024	2079	2299	2345	2375	2424
SCH3624	2310	2574	2626	2675	2724

- Hinged doors attached
- Liner sold separately, see LNRWH30, 36
- Ventilator sold separately, see VNT-01

Liner for Canopy Wood Hood

LNRWH30	271
LNRWH36	314

- Silver metallic powder coated finish

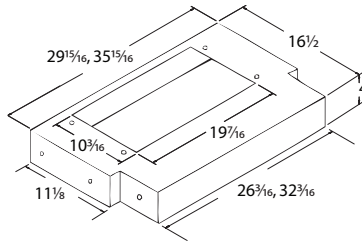

Canopy wood hood liner

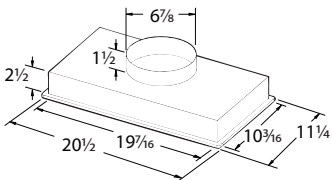

Ventilator for Canopy Wood Hood

VNT-01	489
--------	-----

- 250 CFM / 8 Sones. Silver metallic finish
- Two-speed motor, rocker control
- Dual 40 watt lighting (not included; recommended bulbs: two 40 watt small base candelabra bulbs)





Item Description	Maple
-------------------------	-------

Wall Accessories

Wine Racks

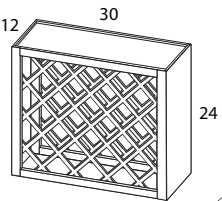

WR2430	751
WR3024	751

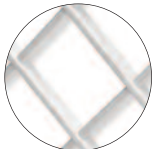
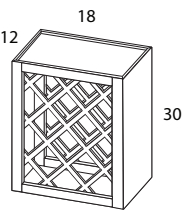

WR1830	693
WR3018	693

- All wood construction
- Finished interior & ends
- Bottle openings are 4" x 4"
- Panels produced from moldings 3/4" thick x 7/16" wide with radiused edges
- Depth modifications not available

Straight Valance

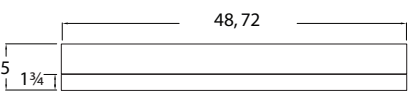

V48	89
V72	101

- 3/4" Thick
- Solid wood construction

Bar Bracket

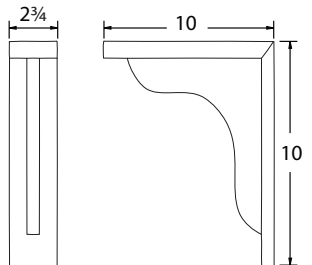

BB10	91
------	----

- 3/4" Thick
- Solid wood construction



WALL CABINETS



Item Description	A	B	C	D	E
	Concord Maple Franklin Maple	Concord RP Maple Dover Maple Franklin RP Maple	Albany Maple	Lawrence Maple Atlanta Maple	Atlanta RP Maple

Base Cabinets, 34 1/2" High

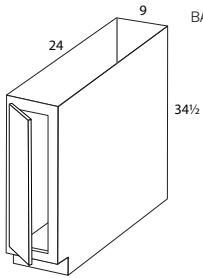

BASE TRAY DIVIDER CABINET

BT9	283	299	305	308	353
-----	-----	-----	-----	-----	-----

- No shelf
- Specify L/R hinge
- 4 1/2" Toe kick

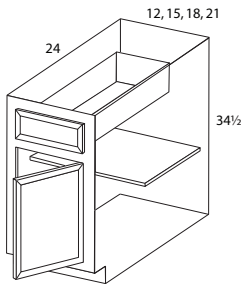

B12	353	379	387	391	454
B15	371	398	406	412	476
B18	392	421	430	437	506
B21	414	443	452	460	532

- 1 Adj. 1/2 depth shelf
- Specify L/R hinge
- 4 1/2" Toe kick

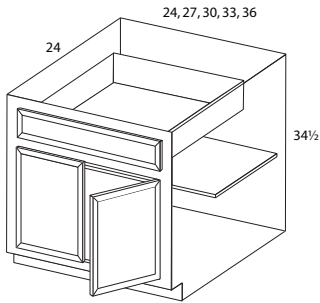

B24	527	568	580	587	658
B27	545	584	596	605	698
B30	588	631	644	653	736
B33	619	664	678	688	776
B36	649	698	712	722	823

- 1 Adj. 1/2 depth shelf
- 1 Drawer
- Butt doors
- 4 1/2" Toe kick

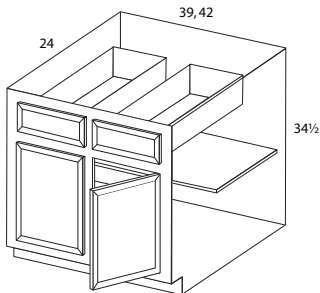

B39	781	828	845	848	970
B42	815	865	883	888	1015

- 1 Adj. 1/2 depth shelf
- 2 Drawers
- 4 1/2" Toe kick



Item Description	A	B	C	D	E
	Concord Maple Franklin Maple	Concord RP Maple Dover Maple Franklin RP Maple	Albany Maple	Lawrence Maple Atlanta Maple	Atlanta RP Maple

Base Cabinets, 34 1/2" High

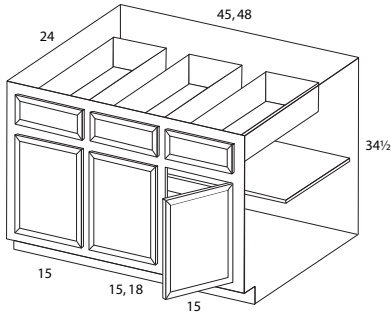

B45	1016	1058	1080	1098	1217
B48	1058	1094	1116	1146	1255

- 1 Adj. 1/2 depth shelf
- 3 Drawers
- Doors hinged L, R, R
- 4 1/2" Toe kick

Sink/Range Base Cabinets, 34 1/2" High

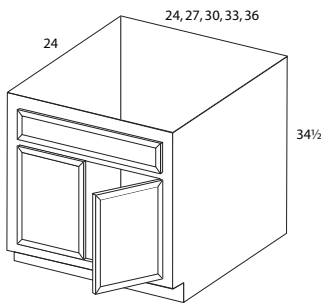

SRB24	432	458	468	479	501
SRB27	460	486	496	508	531
SRB30	479	510	521	531	562
SRB33	499	538	549	559	597
SRB36	517	557	569	577	632

- No shelf
- 1 Drawer front
- Butt doors
- 4 1/2" Toe kick

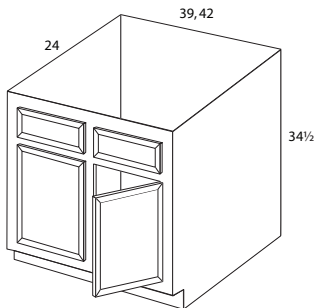

SRB39	540	580	592	601	694
SRB42	562	602	615	625	722

- No shelf
- 2 Drawer fronts
- 4 1/2" Toe kick

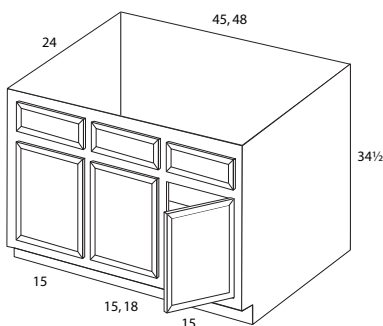

SRB45	653	702	717	726	812
SRB48	704	760	776	786	843

- No shelf
- 3 Drawer fronts
- Doors hinged L, R, R
- 4 1/2" Toe kick



Item Description	A	B	C	D	E
Concord Maple Franklin Maple		Concord RP Maple Dover Maple Franklin RP Maple	Albany Maple	Lawrence Maple Atlanta Maple	Atlanta RP Maple

Base Cabinet with Pullout Shelves , 34 1/2" High

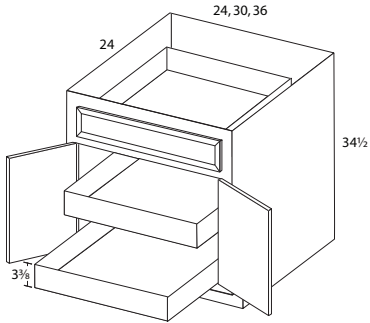

BWPS24	987	1012	1033	1035	1054
BWPS30	1069	1097	1119	1119	1149
BWPS36	1156	1186	1210	1208	1251

- 1 Top drawer
- Butt doors
- 2 Pullout dovetail shelves have full extension ball-bearing drawer guides
- Depth modifications not available
- 4 1/2" Toe kick



Item Description			
Concord Maple Concord RP Maple Dover Maple Franklin Maple Franklin RP Maple		Albany Maple	Atlanta Maple Atlanta RP Maple Lawrence Maple

Base Triple Drawer, 34 1/2" High

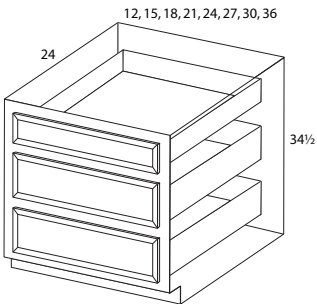

BTD12	779	787	793
BTD15	817	833	857
BTD18	869	886	920
BTD21	907	916	984
BTD24	974	993	1047
BTD27	998	1008	1114
BTD30	1022	1042	1150
BTD36	1132	1155	1238

- 3 Drawers
- 4 1/2" Toe kick



Item Description	A	B	C	D	E
	Concord Maple Franklin Maple	Concord RP Maple Dover Maple Franklin RP Maple	Albany Maple	Lawrence Maple Atlanta Maple	Atlanta RP Maple

Sink Fronts, 34 1/2" High

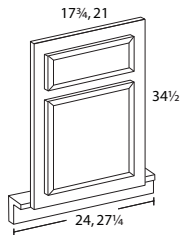

DCSF	239	303	310	315	362
DCSF39	257	328	335	339	392

- Not trimmable
- 4 1/2" Toe kick

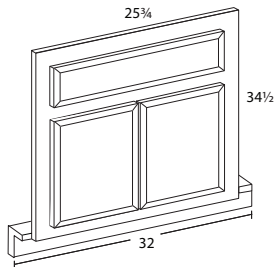

DCSF42	286	359	367	372	432
--------	-----	-----	-----	-----	-----

- Not trimmable
- 4 1/2" Toe kick

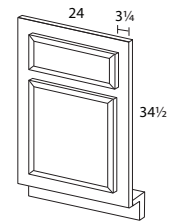

SF24	259	328	335	339	393
------	-----	-----	-----	-----	-----

- Trimmable to 1 1/2" each side
- 4 1/2" Toe kick

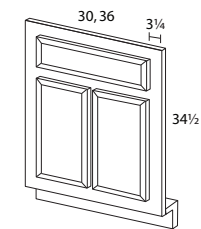

SF30	268	338	345	350	404
SF36	278	351	359	364	420

- Trimmable to 1 1/2" each side
- Butt doors
- 4 1/2" Toe kick

BASE CABINETS



Item Description	A	B	C	D	E
	Concord Maple Franklin Maple	Concord RP Maple Dover Maple Franklin RP Maple	Albany Maple	Lawrence Maple Atlanta Maple	Atlanta RP Maple

Peninsula Base, 34 1/2" High

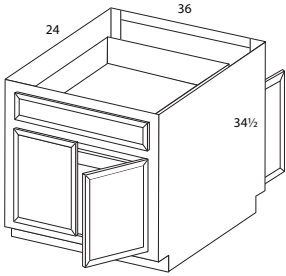

PB36	982	1040	1061	1058	1202
------	-----	------	------	------	------

- 1 Drawer
- Butt doors
- 1 Adj. full depth shelf
- 4 1/2" Toe kick

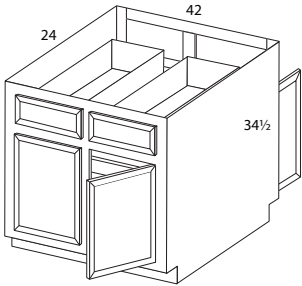

PB42	1217	1306	1333	1328	1464
------	------	------	------	------	------

- 2 Drawers
- 1 Adj. full depth shelf
- 4 1/2" Toe kick

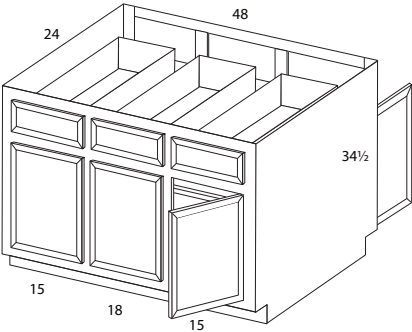

PB48	1521	1628	1661	1663	1798
------	------	------	------	------	------

- 3 Drawers
- 1 Adj. full depth shelf
- Doors hinged L, R, R
- 4 1/2" Toe kick

Base Lazy Susan, 34 1/2" High

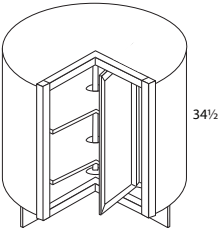

BLS36	722	729*	NA	NA	NA
OBLS36	NA	1007*	1028	1048	1176

- 24" Diameter rotating polymer shelves
- BLS/OBLS back: is not constructed of all plywood
- OBLS36: cabinet has double face frame
- 4 1/2" Toe kick shipped loose

*BLS36 - Available in 1/2" overlay doors (Concord, Concord Raised Panel, Franklin, Franklin Raised Panel)

*OBLS36 - Available in 1 9/16" overlay doors (Albany, Atlanta, Atlanta Raised Panel, Dover, Lawrence)



Item Description	A	B	C	D	E
Concord Maple Franklin Maple					
Concord RP Maple Dover Maple Franklin RP Maple					
Albany Maple					
Lawrence Maple Atlanta Maple					
Atlanta RP Maple					

Corner Sink Base, 34 1/2" High

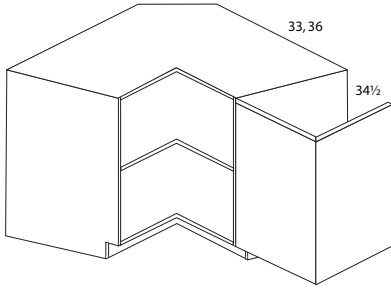

CSB33	891	964	984	972	1137
CSB36	899	971	991	979	1144

- Fixed shelf
- Plywood ends
- Specify finish ends if ends exposed
- 4 1/2" Toe kick

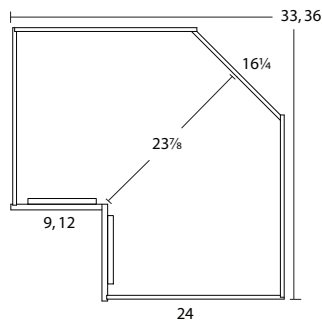

BASE CABINETS

Corner Susan Base, 34 1/2" High

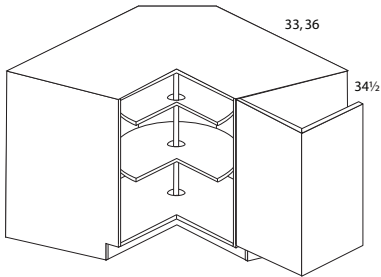

CS33	1450	1511	1542	1607	1691
CS36	1461	1523	1554	1617	1701

- 33" Wide: (2) - 24" Diameter rotating polymer shelves
- 36" Wide: (2) - 28" Diameter rotating polymer shelves
- Plywood ends
- Specify finish ends if ends exposed
- 4 1/2" Toe kick

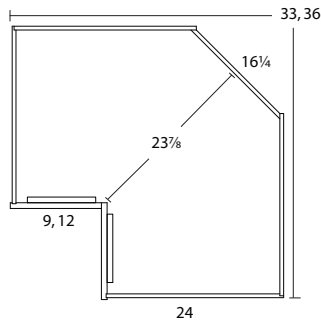



Item Description	A	B	C	D	E
	Concord Maple Franklin Maple	Concord RP Maple Dover Maple Franklin RP Maple	Albany Maple	Lawrence Maple Atlanta Maple	Atlanta RP Maple

Super Susan Base, 34 1/2" High

SSB36	1469	1586	1618	1598	1844
-------	------	------	------	------	------

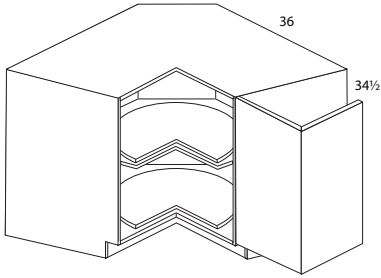

- (2) - 32" Diameter wood susans mounted to shelves
- Plywood ends
- Specify finish ends if ends exposed
- 4 1/2" Toe kick

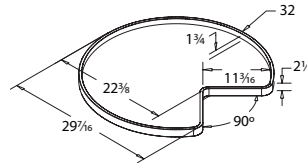
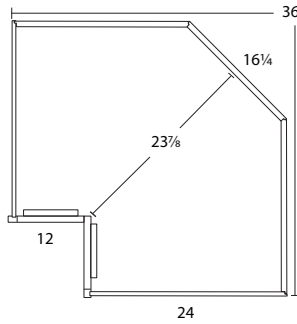

Diagonal Corner Sink Base, 34 1/2" High

DCSB36	991	1070	1092	1079	1260
--------	-----	------	------	------	------

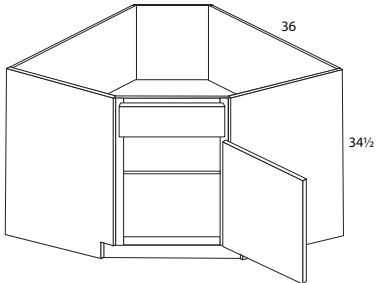

- 3/4" Thick adj. shelf
- 1 Drawer front, standard height door
- Plywood ends
- Specify finish ends if ends exposed
- No top
- 4 1/2" Toe kick

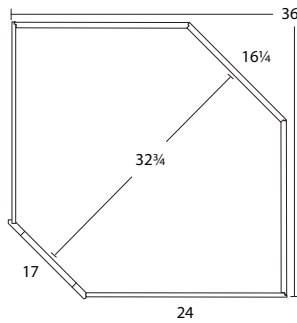



Item Description	A	B	C	D	E
Concord Maple Franklin Maple					
Concord RP Maple Dover Maple Franklin RP Maple					
Albany Maple					
Lawrence Maple Atlanta Maple					
Atlanta RP Maple					

Corner Blind Base Installation

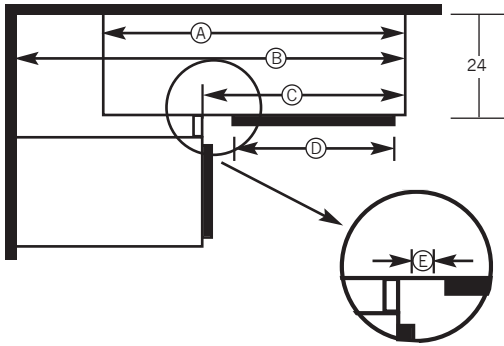

On all 1 9/16" overlay door styles, the adjoining cabinet requires a minimum 1 1/4" filler when installing without hardware. Requires 2 1/4" filler when installing hardware.

- A = CABINET WIDTH
- B = DISTANCE FROM WALL PULLED INCLUDING CABINET WIDTH
- C = WIDTH OF REVEALED CABINET
- D = DOOR WIDTH
- E = DOOR REVEAL

		A	B		C	D	E
			MIN	MAX			
CB36	STD OVERLAY		36	40 ^{3/4}		9 ^{1/2}	1 ^{1/4}
	1 9/16 OVERLAY	27	37 ^{7/16}		12	11 ^{5/8}	3 ^{3/16}
CB39	STD OVERLAY		39	43 ^{3/4}		12 ^{1/2}	1 ^{1/4}
	1 9/16 OVERLAY	33	40 ^{7/16}		15	14 ^{5/8}	3 ^{3/16}
CB42	STD OVERLAY		42	46 ^{3/4}		15 ^{1/2}	1 ^{1/4}
	1 9/16 OVERLAY	39	43 ^{7/16}		18	17 ^{5/8}	3 ^{3/16}
CB45	STD OVERLAY		45	49 ^{3/4}		18 ^{1/2}	1 ^{1/4}
	1 9/16 OVERLAY	45	46 ^{7/16}		21	20 ^{5/8}	3 ^{3/16}
CB48	STD OVERLAY		48	51 ^{1/4}	22 ^{1/2}	20	1 ^{1/4}
	1 9/16 OVERLAY	48	49 ^{7/16}			22 ^{1/8}	3 ^{3/16}
SCB54	STD OVERLAY		54	58 ^{3/4}	30	27 ^{1/2}	1 ^{1/4}
	1 9/16 OVERLAY	54	55 ^{7/16}			29 ^{5/8}	3 ^{3/16}
SCB57	STD OVERLAY		57	61 ^{3/4}	33	30 ^{1/2}	1 ^{1/4}
	1 9/16 OVERLAY	57	58 ^{7/16}			32 ^{5/8}	3 ^{3/16}
SCB60	STD OVERLAY		60	64 ^{3/4}	36	33 ^{1/2}	1 ^{1/4}
	1 9/16 OVERLAY	60	61 ^{7/16}			35 ^{5/8}	3 ^{3/16}

BASE CABINETS

Corner Blind Base, 34 1/2" High

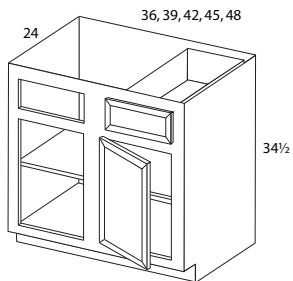

CB36	494	534	545	553	602
CB39	517	553	565	572	652
CB42	527	571	583	590	689
CB45	556	596	608	618	715
CB48	607	655	669	679	787

- 1 Adj. 1/2 depth shelf
- Specify blind L/R
- Door hinged to mullion
- 4 1/2" Toe kick

	CB36	CB39	CB42	CB45	CB48
Mullion	6 ^{1/2} "	6 ^{1/2} "	6 ^{1/2} "	6 ^{1/2} "	6 ^{1/2} "
Blind Opening	8 ^{1/2} "	11 ^{1/2} "	14 ^{1/2} "	17 ^{1/2} "	19"

Corner Blind Sink Base, 34 1/2" High

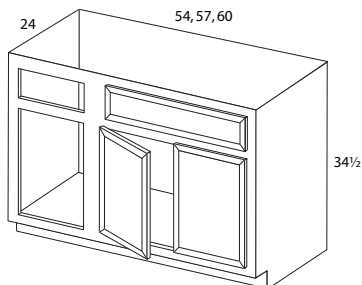

SCB54	632	670	684	702	719
SCB57	662	706	721	733	748
SCB60	685	736	751	758	779

- No shelf
- 1 Drawer front
- Butt doors
- Specify blind L/R
- Door hinged to mullion
- 4 1/2" Toe kick

	SCB54	SCB57	SCB60
Mullion	6 ^{1/2} "	6 ^{1/2} "	6 ^{1/2} "
Blind Opening	17 ^{1/2} "	17 ^{1/2} "	17 ^{1/2} "



Item Description	Concord Maple Concord RP Maple Dover Maple Franklin Maple Franklin RP Maple	Albany Maple	Atlanta Maple Atlanta RP Maple Lawrence Maple
------------------	---	--------------	---

Base Microwave Cabinet, 34 1/2" High

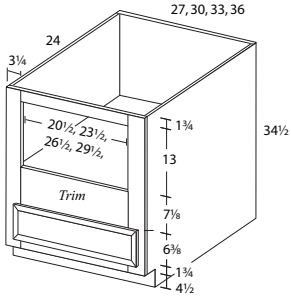

BMC27	624	636	651
BMC30	638	651	690
BMC33	667	680	728
BMC36	692	706	773

- 1 Drawer
- Adjustable floor
- 4 1/2" Toe kick



Item Description	A Concord Maple Franklin Maple	B Concord RP Maple Dover Maple Franklin RP Maple	C Albany Maple	D Lawrence Maple Atlanta Maple	E Atlanta RP Maple
------------------	--------------------------------------	---	-------------------	--------------------------------------	-----------------------

Trash Can Base Cabinet, 34 1/2" High

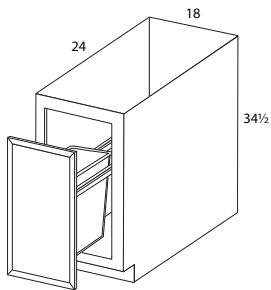

TC18	578	607	620	754	836
------	-----	-----	-----	-----	-----

- Includes (1) - 50 qt. trash can
- Includes storage space for trash bags
- Decrease depth not available
- Full extension ball bearing slides
- 4 1/2" Toe kick

Matching Base End Panel, 34 1/2" High

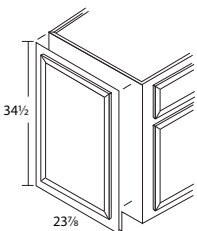

MBEP	203	259	265	268	308
------	-----	-----	-----	-----	-----

- 3/16" Plywood panel
- Panel & door shipped loose
- Toe space field notched

Door Dimensions

1/2" Overlay	1 1/16" Overlay
21 1/2" W x 27 1/2" H	23 5/8" W x 29 3/8" H



Item Description	Maple
-------------------------	-------

Base Accessories

Base End Panel

BEP	110
-----	-----

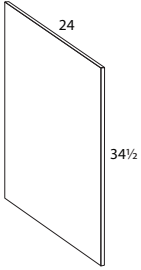

- 1/2" hardwood veneer on one side with front edgebanded

Base End Panel, 3" or 6" Stile

BEP3	142
BEP6	169

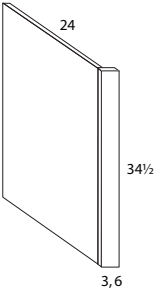

- 1/2" plywood with 3" or 6" stiles

Desk End Panel

DEP	137
-----	-----

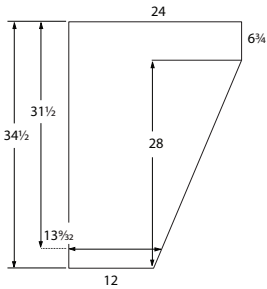

- 3/4" Plywood, finished on both sides
- Trimmable to desired height

Sink Front Flooring

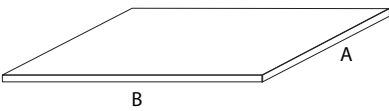

SFF24	81
SFF36	90
SFF48	99
SFF3636	91
SFF4242	96

	A	B
SFF24	23-1/8"	22-5/16"
SFF36	23-1/8"	34-5/16"
SFF48	23-1/8"	46-5/16"
SFF3636	36-1/2"	36-1/2"
SFF4242	42-1/2"	42-1/2"

- 1/2" plywood



Item Description	A	B	C	D	E
	Concord Maple Franklin Maple	Concord RP Maple Dover Maple Franklin RP Maple	Albany Maple	Lawrence Maple Atlanta Maple	Atlanta RP Maple

Universal Access Base Cabinets, 32 1/2" High

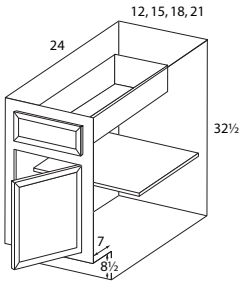

UAB12	353	379	387	391	452
UAB15	371	398	406	412	476
UAB18	392	421	430	437	506
UAB21	414	443	452	460	532

- 1 Adj. 1/2 depth shelf
- Specify L/R hinge
- 8 1/2" High x 7" Deep toe kick

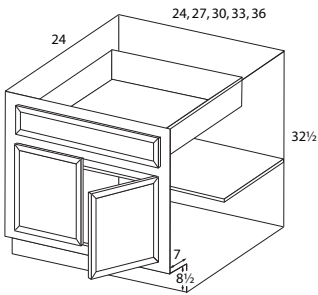

UAB24	527	568	580	587	621
UAB27	545	584	596	605	652
UAB30	588	631	644	653	708
UAB33	619	664	678	688	748
UAB36	649	698	712	722	790

- 1 Adj. 1/2 depth shelf
- 1 Drawer
- Butt doors
- 8 1/2" High x 7" Deep toe kick



Item Description	A	B	C	D	E
Concord Maple Franklin Maple	Concord RP Maple Dover Maple Franklin RP Maple	Albany Maple	Lawrence Maple Atlanta Maple	Atlanta RP Maple	

Universal Access Base Cabinets with Full Height Door, 32 1/2" High

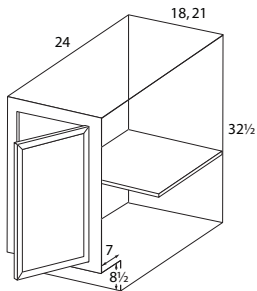

UABFH18	327	351	359	364	422
UABFH21	345	369	377	383	443

- 1 Adj. 1/2 depth shelf
- Specify L/R hinge
- 8 1/2" High x 7" Deep toe kick

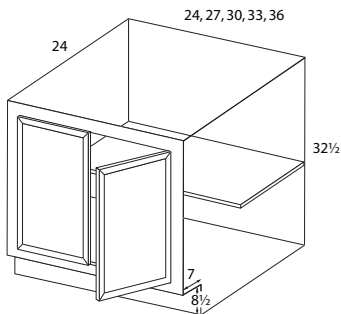

UABFH24	439	473	483	489	568
UABFH27	454	487	497	504	585
UABFH30	490	526	537	544	632
UABFH33	516	553	565	573	665
UABFH36	541	582	594	602	697

- 1 Adj. 1/2 depth shelf
- Butt doors
- 8 1/2" High x 7" Deep toe kick

Universal Access Floating Sink Base Cabinet, 23 1/2" High

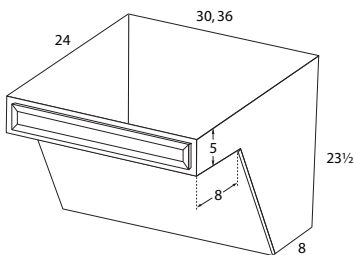

UAFSB30	460	494	504	537	565
UAFSB36	509	546	557	594	624

- 1 Drawer front
- 1/2" Plywood
- **Slab drawer front standard; 5 piece option not available**
- Removable front panel; no edgebanding
- Removable front panel protrudes 1/4" on each side to be flush to adjacent cabinet once installed



Item Description	Concord Maple Concord RP Maple Dover Maple Franklin Maple Franklin RP Maple	Albany Maple	Atlanta Maple Atlanta RP Maple Lawrence Maple
-------------------------	---	--------------	---

Universal Access Drawer Base, 32 1/2" High

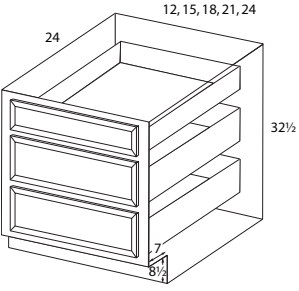

UADB12	701	708	717
UADB15	754	769	773
UADB18	810	818	829
UADB21	867	876	886
UADB24	922	931	943

- 3 Drawers
- 8 1/2" High x 7" Deep toe kick



Item Description	A	B	C	D	E
Concord Maple Franklin Maple					
Concord RP Maple Dover Maple Franklin RP Maple					
Albany Maple					
Lawrence Maple Atlanta Maple					
Atlanta RP Maple					

Universal Access Corner Sink Base, 32 1/2" High

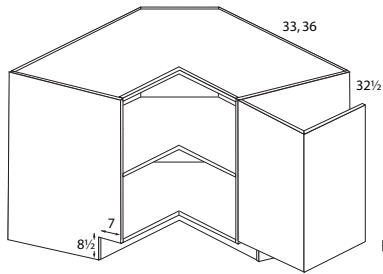

UACSB33	891	964	984	972	1137
UACSB36	899	971	991	1144	1144

- Fixed shelf
- Plywood ends
- Specify finish ends if ends exposed
- 8 1/2" High x 7" Deep toe kick

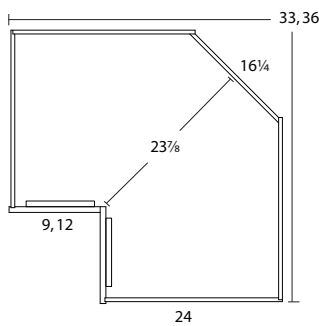

Universal Access Super Susan Base, 32 1/2" High

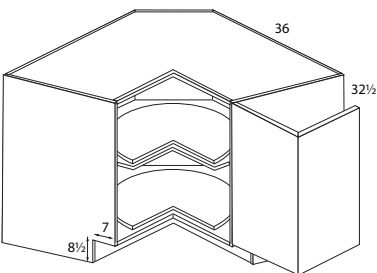

UASSB36	1469	1586	1618	1598	1844
---------	------	------	------	------	------

- (2) - 32" Diameter wood susans mounted to shelves
- Plywood ends
- Specify finish ends if ends exposed
- 8 1/2" High x 7" Deep toe kick

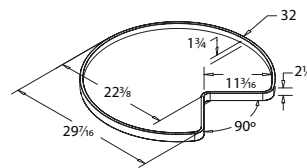
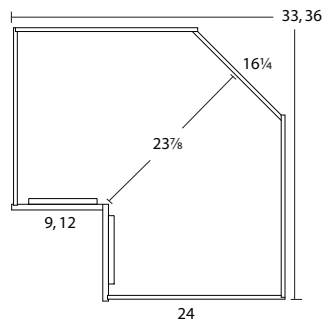

UNIVERSAL CABINETS



Item Description	A	B	C	D	E
Concord Maple Franklin Maple	Concord RP Maple Dover Maple Franklin RP Maple	Albany Maple	Lawrence Maple Atlanta Maple	Atlanta RP Maple	

Universal Access Diagonal Corner Sink Base, 32 1/2" High

UADCSB36	991	1070	1092	1079	1260
----------	-----	------	------	------	------

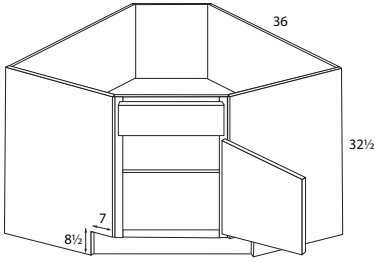

- 3/4" Thick adj. shelf
- 1 Drawer front, standard height door
- Plywood ends
- Specify finish ends if ends exposed
- No top
- 8 1/2" High x 7" Deep toe kick

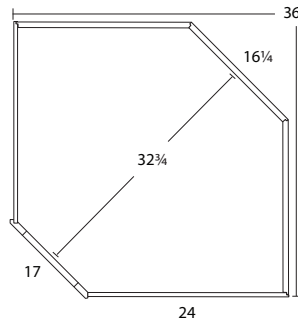

Item Description	Concord Maple Concord RP Maple Dover Maple Franklin Maple Franklin RP Maple	Albany Maple	Atlanta Maple Atlanta RP Maple Lawrence Maple
------------------	---	--------------	---

Universal Access Base Microwave Cabinet, 32 1/2" High

UABMC27	624	636	651
UABMC30	638	651	690
UABMC33	667	680	728
UABMC36	692	706	773

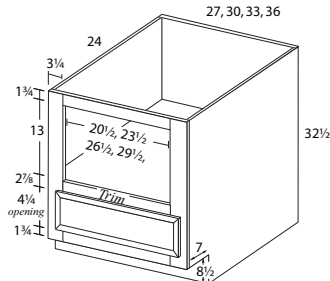

- 1 Drawer
- Adjustable floor
- 8 1/2" High x 7" Deep toe kick



Item Description	A	B	C	D	E
Concord Maple Franklin Maple					
Concord RP Maple Dover Maple Franklin RP Maple					
Albany Maple					
Lawrence Maple Atlanta Maple					
Atlanta RP Maple					

Corner Blind Base Installation

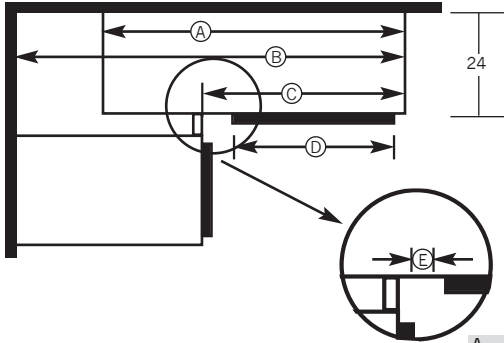

On all 1 9/16" overlay door styles, the adjoining cabinet requires a minimum 1 1/4" filler when installing without hardware. Requires 2 1/4" filler when installing hardware.

- A = CABINET WIDTH
- B = DISTANCE FROM WALL PULLED INCLUDING CABINET WIDTH
- C = WIDTH OF REVEALED CABINET
- D = DOOR WIDTH
- E = DOOR REVEAL

		A	B		C	D	E
			MIN	MAX			
UACB36	STD OVERLAY	27	36	40 ^{3/4}	12	9 ^{1/2}	1 ^{1/4}
	1 9/16 OVERLAY	37 ^{7/16}	11 ^{5/8}				
UACB39	STD OVERLAY	33	39	43 ^{3/4}	15	12 ^{1/2}	1 ^{1/4}
	1 9/16 OVERLAY	40 ^{7/16}	14 ^{5/8}				
UACB42	STD OVERLAY	39	42	46 ^{3/4}	18	15 ^{1/2}	1 ^{1/4}
	1 9/16 OVERLAY	43 ^{7/16}	17 ^{5/8}				
UACB45	STD OVERLAY	45	45	49 ^{3/4}	21	18 ^{1/2}	1 ^{1/4}
	1 9/16 OVERLAY	46 ^{7/16}	20 ^{5/8}				
UACB48	STD OVERLAY	48	48	51 ^{1/4}	22 ^{1/2}	20	1 ^{1/4}
	1 9/16 OVERLAY	49 ^{7/16}	22 ^{1/8}				

Universal Access Corner Blind Base, 32 1/2" High

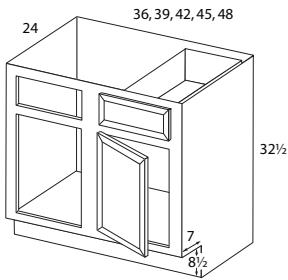

	UACB36	UACB39	UACB42	UACB45	UACB48
UACB36	493	503	514	510	537
UACB39	517	551	563	547	585
UACB42	527	571	583	588	610
UACB45	556	596	608	618	680
UACB48	607	620	633	646	656

- No shelf
- Specify blind L/R
- Door hinged to mullion
- 8 1/2" High x 7" Deep toe kick

	UACB36	UACB39	UACB42	UACB45	UACB48
Mullion	6 ^{1/2} "	6 ^{1/2} "	6 ^{1/2} "	6 ^{1/2} "	6 ^{1/2} "
Blind Opening	8 ^{1/2} "	11 ^{1/2} "	14 ^{1/2} "	17 ^{1/2} "	19"

UNIVERSAL CABINETS



Item Description	A	B	C	D	E
	Concord Maple Franklin Maple	Concord RP Maple Dover Maple Franklin RP Maple	Albany Maple	Lawrence Maple Atlanta Maple	Atlanta RP Maple

Universal Access Trash Base Cabinet, 32 1/2" High

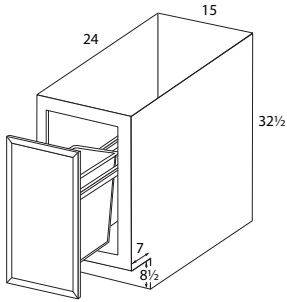

UATC15	578	607	620	754	836
--------	-----	-----	-----	-----	-----

- Includes (1) 35 qt. trash can
- Includes storage space for trash bags
- Full extension ball-bearing slides
- Decrease depth not available
- 8 1/2" High x 7" Deep toe kick

Universal Access Matching Base End Panel, 32 1/2" High

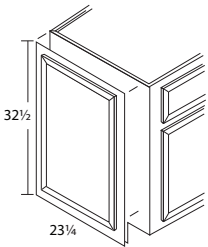

UAMBEP	203	259	265	268	308
--------	-----	-----	-----	-----	-----

- 3/16" Plywood panel
- Panel & door shipped loose
- Toe space field notched

Door Dimensions

1/2" Overlay	1 1/16" Overlay
21 1/2" W x 21 1/2" H	23 5/8" W x 23 5/8" H



Item Description	Maple

Universal Access Toe Space Cover, 8 1/2" High

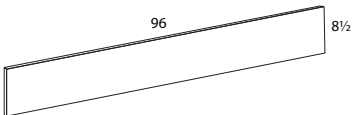

TSC8 1/2	75
----------	----

- 1/4" Thick plywood
- Required on all base & tall universal access cabinets



Item Description	A	B	C	D	E
	Concord Maple Franklin Maple	Concord RP Maple Dover Maple Franklin RP Maple	Albany Maple	Lawrence Maple Atlanta Maple	Atlanta RP Maple

Universal Access Oven Cabinet Installation Guide

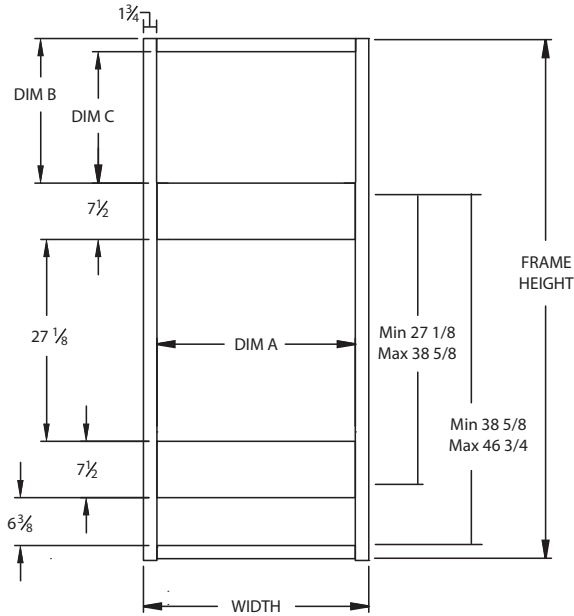

CABINET WIDTH	DIM A	
	MIN	MAX
30	26 1/2	28 1/2
33	29 1/2	31 1/2
36	32 1/2	34 1/2

CABINET HEIGHT	FRAME HEIGHT	DIM B	DIM C
84	75 1/2	25 1/4	23 1/2

• All oven cabinets can be cut to fit a majority of oven units manufactured

Universal Access Oven Cabinets, 84" High

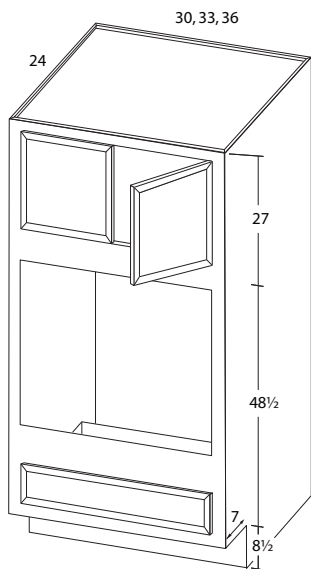

UAO3084	1012	1089	1111	1128	1305
UAO3384	1081	1164	1188	1206	1396
UAO3684	1161	1250	1275	1295	1500

- No shelf
- Butt doors
- 1 Drawer
- Custom cutout modifications not available
- 8 1/2" High x 7" Deep toe kick
- Toe kick shipped attached, specify loose

UNIVERSAL CABINETS



Item Description	A	B	C	D	E
	Concord Maple Franklin Maple	Concord RP Maple Dover Maple Franklin RP Maple	Albany Maple	Lawrence Maple Atlanta Maple	Atlanta RP Maple

Oven Cabinet Installation

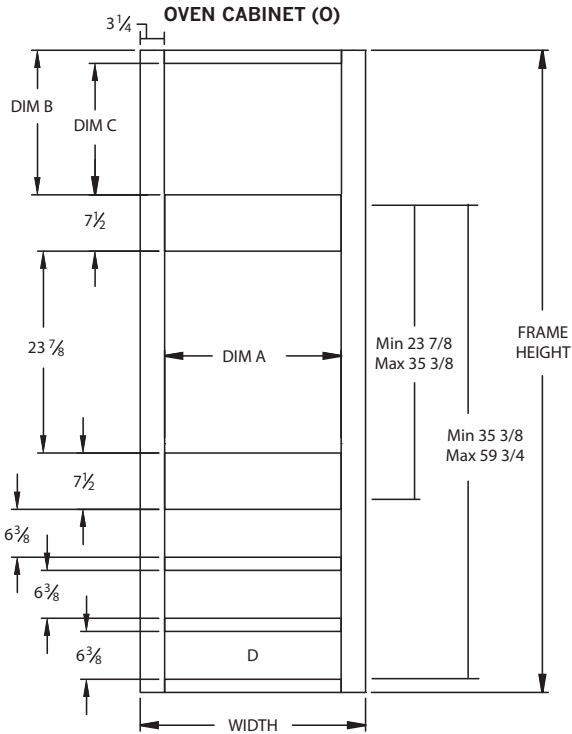

CABINET WIDTH	DIM A	
	MIN	MAX
27	20 1/2	25 1/2
30	23 1/2	28 1/2
33	26 1/2	31 1/2

CABINET HEIGHT	FRAME HEIGHT	DIM B	DIM C
84	79 1/2	16 1/4	14 1/2
90	85 1/2	22 1/4	20 1/2
96	91 1/2	28 1/4	26 1/2

- Three openings for drawers, bottom drawer furnished.
- Additional drawers may be purchased, See oven drawers pg. 51.
- All oven cabinets can be cut to fit a majority of oven units manufactured.

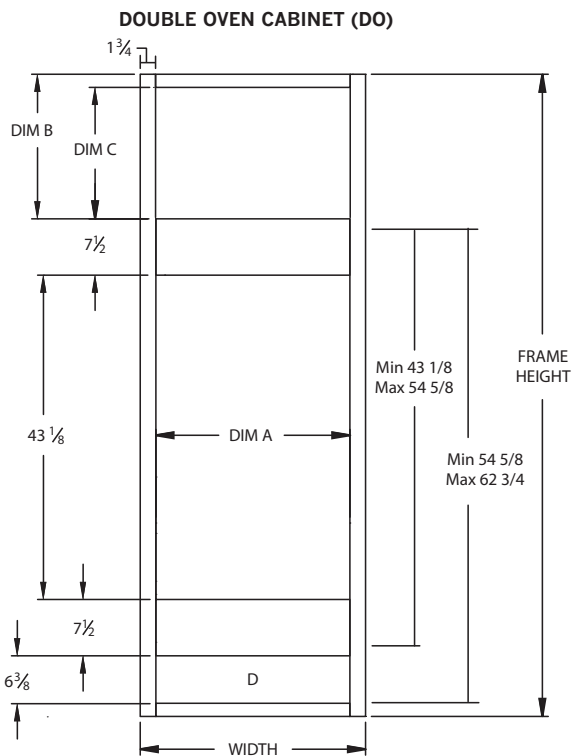

CABINET WIDTH	DIM A	
	MIN	MAX
30	26 1/2	28 1/2
33	29 1/2	31 1/2
36	32 1/2	34 1/2

CABINET HEIGHT	FRAME HEIGHT	DIM B	DIM C
84	79 1/2	13 1/4	11 1/2
90	85 1/2	19 1/4	17 1/2
96	91 1/2	25 1/4	23 1/2

- Double oven cabinets furnished with one drawer
- Toe kick shipped attached, specify loose



Item Description	Concord Maple Concord RP Maple Dover Maple Franklin Maple Franklin RP Maple	Albany Maple	Atlanta Maple Atlanta RP Maple Lawrence Maple
-------------------------	---	--------------	---

Oven Drawer

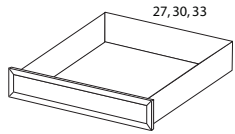

OD27	220	224	238
OD30	233	238	255
OD33	272	277	283

- Applies only to Oven Cabinets (O27, O30, O33)
- Drawer guide assembly included



Item Description	A	B	C	D	E
	Concord Maple Franklin Maple	Concord RP Maple Dover Maple Franklin RP Maple	Albany Maple	Lawrence Maple Atlanta Maple	Atlanta RP Maple

84", 90", 96" High Oven Cabinets

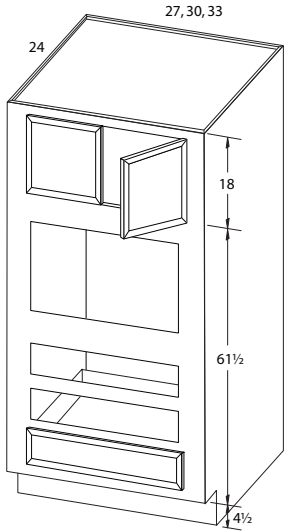

02784	928	1001	1022	1036	1203
03084	1012	1089	1111	1128	1305
03384	1081	1164	1188	1206	1396

- No shelf
- Butt doors
- Three openings for drawers; 1 drawer furnished (bottom)
- Custom cutout modifications not available
- 4 1/2" Toe kick shipped attached, specify loose
- See installation guide pg. 54 for specifications & width and height cutout dimensions

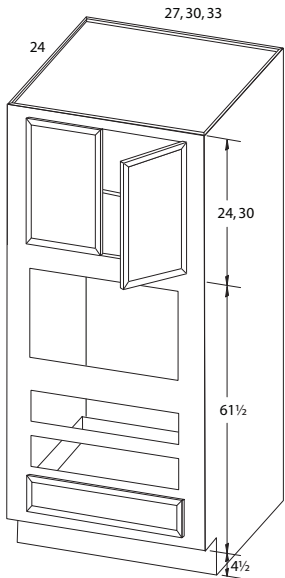

02790	1023	1100	1122	1140	1318
03090	1103	1186	1210	1229	1422
03390	1169	1261	1287	1305	1507
02796	1115	1201	1226	1244	1439
03096	1197	1288	1314	1334	1543
03396	1255	1352	1380	1400	1619

- 1/2 Depth shelf
- Butt doors
- Three openings for drawers; 1 drawer furnished (bottom)
- Custom cutout modifications not available
- 4 1/2" Toe kick shipped attached, specify loose
- See installation guide pg. 54 for specifications & width and height cutout dimensions



Item Description	A	B	C	D	E
Concord Maple Franklin Maple					
Concord RP Maple Dover Maple Franklin RP Maple					
Albany Maple					
Lawrence Maple Atlanta Maple					
Atlanta RP Maple					

84", 90", 96" High Double Oven Cabinets

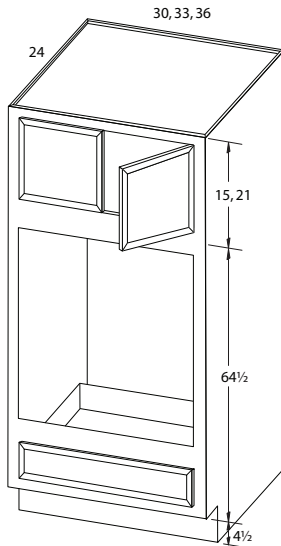

D03084	1012	1089	1111	1128	1305
D03384	1081	1164	1188	1206	1396
D03684	1181	1264	1290	1306	1496
D03090	1103	1186	1210	1229	1422
D03390	1169	1261	1287	1305	1507
D03690	1269	1361	1389	1405	1607

- No shelf
- Butt doors
- One Drawer
- Custom cutout modifications not available
- 4 1/2" Toe kick shipped attached, specify loose
- See installation guide pg. 54 for specifications & width and height cutout dimensions

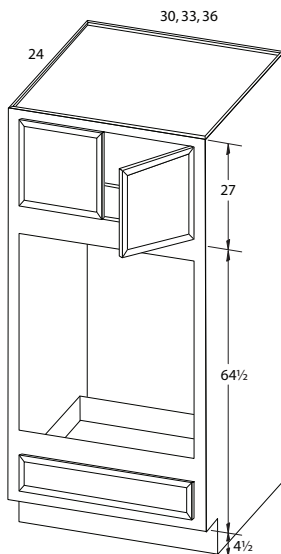

D03096	1197	1288	1314	1334	1543
D03396	1255	1352	1380	1400	1619
D03696	1355	1452	1482	1500	1719

- 1/2 Depth shelf
- Butt doors
- One Drawer
- Custom cutout modifications not available
- 4 1/2" Toe kick shipped attached, specify loose
- See installation guide pg. 54 for specifications & width and height cutout dimensions



Item Description	A	B	C	D	E
	Concord Maple Franklin Maple	Concord RP Maple Dover Maple Franklin RP Maple	Albany Maple	Lawrence Maple Atlanta Maple	Atlanta RP Maple

84", 90", 96" High Utility Cabinets

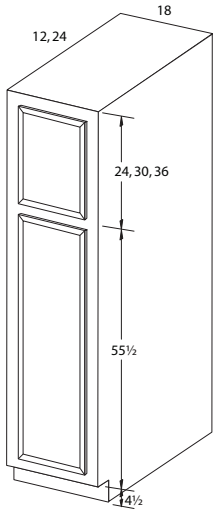

U181284	664	712	727	738	858
U182484	778	837	854	867	1002
U181290	719	758	774	785	895
U182490	829	877	895	908	1033
U181296	783	783	799	810	965
U182496	891	920	939	952	1099

- Top section has 1/2 depth shelf
- **The following door styles will have a 2-piece panel on bottom door: Dover, Concord, Concord RP, Lawrence; All other door styles will have a 1-piece panel on bottom door**
- 4 1/2" Toe kick shipped attached, specify loose
- Shelving & pullouts sold separately, pg. 71-72

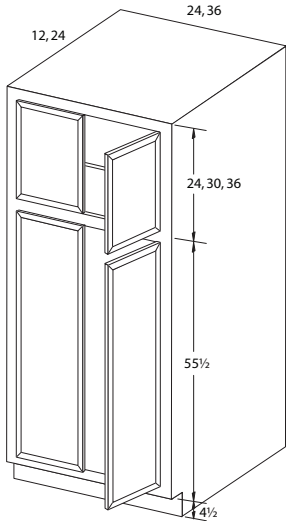

U241284	806	860	878	890	1028
U242484	877	940	959	974	1135
U361284	1165	1203	1228	1245	1454
U362484	1279	1321	1348	1367	1595
U241290	885	912	931	945	1093
U242490	990	1021	1042	1057	1223
U361290	1231	1270	1296	1315	1520
U362490	1390	1434	1463	1486	1719
U241296	966	974	994	1010	1188
U242496	1047	1055	1077	1093	1285
U361296	1379	1422	1451	1472	1731
U362496	1569	1620	1653	1678	1974

- Top section has 1/2 depth shelf
- Butt doors
- **The following door styles will have a 2-piece panel on bottom door: Dover, Concord, Concord RP, Lawrence; All other door styles will have a 1-piece panel on bottom door**
- 4 1/2" Toe kick shipped attached, specify loose
- Shelving & pullouts sold separately, pg. 71-72



Item Description	A	B	C	D	E
	Concord Maple Franklin Maple	Concord RP Maple Dover Maple Franklin RP Maple	Albany Maple	Lawrence Maple Atlanta Maple	Atlanta RP Maple

Matching Tall End Panel

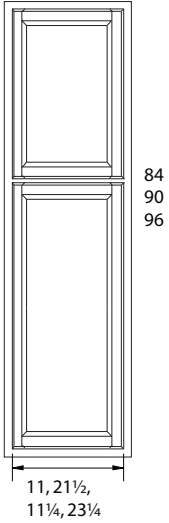

MTEP1284	197	313	320	323	408
MTEP1290	213	341	348	353	436
MTEP1296	238	377	385	390	462

MTEP2484	314	457	467	474	588
MTEP2490	354	506	517	525	621
MTEP2496	392	539	550	558	642

- 3/16" Thick plywood panel
- 12" MTEP: 11 1/4" W panel; door size: 11"
- 24" MTEP: 23 1/4" W panel; door size: 21 1/2"
- Panel & door shipped loose
- Toe space field notched
- **The following door styles will have a 2-piece panel on bottom door: Dover, Concord, Concord RP, Lawrence; All other door styles will have a 1-piece panel on bottom door**

Door Dimensions

H	W	1/2" Overlay	Full Overlay
84"	12"	11" W x 21-1/2" H	11-5/8" W x 23-5/8" H
		11" W x 54-3/4" H	11-5/8" W x 55-5/8" H
	24"	21-1/2" W x 21-1/2" H	23-5/8" W x 23-5/8" H
		21-1/2" W x 54-3/4" H	23-5/8" W x 55-5/8" H
90"	12"	11" W x 27-1/2" H	11-5/8" W x 29-5/8" H
		11" W x 54-3/4" H	11-5/8" W x 55-5/8" H
	24"	21-1/2" W x 27-1/2" H	23-5/8" W x 29-5/8" H
		21-1/2" W x 54-3/4" H	23-5/8" W x 55-5/8" H
96"	12"	11" W x 33-1/2" H	11-5/8" W x 35-5/8" H
		11" W x 54-3/4" H	11-5/8" W x 55-5/8" H
	24"	21-1/2" W x 33-1/2" H	23-5/8" W x 35-5/8" H
		21-1/2" W x 54-3/4" H	23-5/8" W x 55-5/8" H



Item Description	A	B	C	D	E
	Concord Maple Franklin Maple	Concord RP Maple Dover Maple Franklin RP Maple	Albany Maple	Lawrence Maple Atlanta Maple	Atlanta RP Maple

Vanity Base, 31 1/2" High

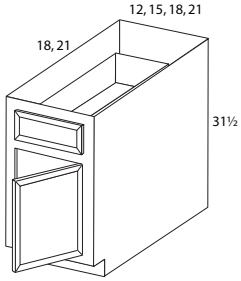

VB12	240	258	264	268	309
VB1218	240	258	264	268	309
VB15	251	272	278	281	322
VB1518	251	272	278	281	322
VB18	294	316	323	326	377
VB1818	294	316	323	326	377
VB21	326	352	360	365	422
VB2118	326	352	360	365	422

- No shelf
- Specify L/R hinge
- 4 1/2" Toe kick

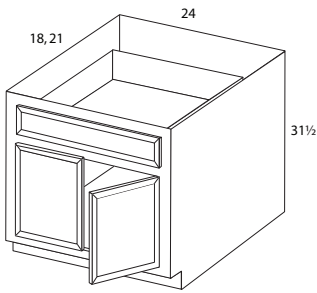

VB24	399	431	440	446	515
VB2418	399	431	440	446	515

- No shelf
- Butt doors
- 4 1/2" Toe kick

Vanity Sink Base, 31 1/2" High

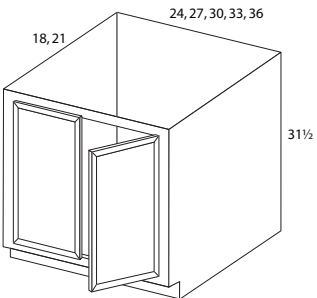

VS24	356	382	390	395	458
VS2418	356	382	390	395	458
VS27	367	396	404	410	472
VS2718	367	396	404	410	472
VS30	369	398	406	413	476
VS3018	369	398	406	413	476
VS33	377	406	415	421	486
VS3318	377	406	415	421	486
VS36	388	418	427	433	500
VS3618	388	418	427	433	500

- No shelf
- Butt doors
- 4 1/2" Toe kick



Item Description	A	B	C	D	E
Concord Maple Franklin Maple					
Concord RP Maple Dover Maple Franklin RP Maple					
Albany Maple					
Lawrence Maple Atlanta Maple					
Atlanta RP Maple					

Vanity Sink Base with Drawer Blanks, 31 1/2" High

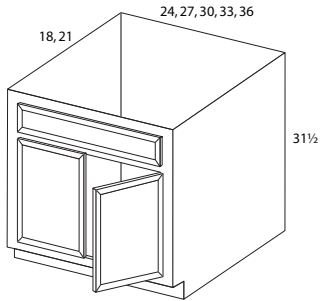

VS24B	378	407	416	422	487
VS2418B	378	407	416	422	487
VS27B	389	420	429	435	502
VS2718B	389	420	429	435	502
VS30B	391	423	432	438	508
VS3018B	391	423	432	438	508
VS33B	402	433	442	449	517
VS3318B	402	433	442	449	517
VS36B	412	445	454	461	534
VS3618B	412	445	454	461	534

- No shelf
- Butt doors
- 4 1/2" Toe kick

Vanity Sink Base with Drawers, 31 1/2" High

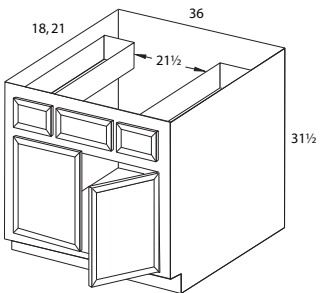

VSB36	545	573	585	592	672
VSB3618	545	573	585	592	672

- No shelf
- Butt doors
- 4 1/2" Toe kick

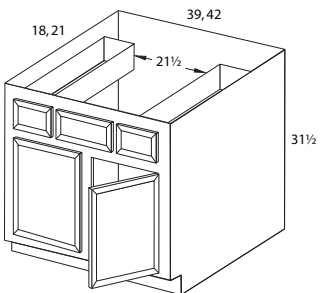

VSB39	568	598	610	616	702
VSB3918	568	598	610	616	702
VSB42	588	622	635	642	732
VSB4218	588	622	635	642	732

- No shelf
- 4 1/2" Toe kick

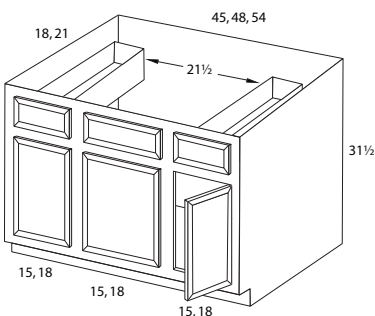

VSB45	640	675	689	697	794
VSB4518	640	675	689	697	794
VSB48	653	689	703	711	811
VSB4818	653	689	703	711	811
VSB54	674	714	729	737	839
VSB5418	674	714	729	737	839

- No shelf
- Doors hinged L, R, R
- 4 1/2" Toe kick



Item Description	A	B	C	D	E
Concord Maple Franklin Maple					
Concord RP Maple Dover Maple Franklin RP Maple					
Albany Maple					
Lawrence Maple Atlanta Maple					
Atlanta RP Maple					

Combination Vanity Sink Base, 31 1/2" High

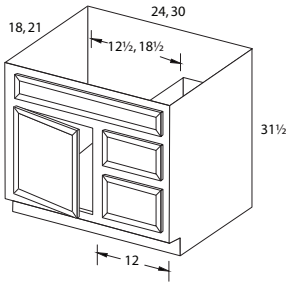

CVS24B	583	614	627	633	720
CVS2418B	583	614	627	633	720
CVS30B	610	644	657	665	757
CVS3018B	610	644	657	665	757

- No shelf
- 1 Drawer blank & 2 deep drawers
- Specify drawers L/R
- 4 1/2" Toe kick

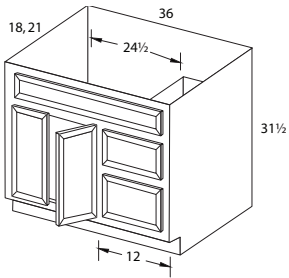

CVS36B	622	658	672	677	772
CVS3618B	622	658	672	677	772

- No shelf
- 1 Drawer blank & 2 deep drawers
- Specify drawers L/R
- Butt doors
- 4 1/2" Toe kick

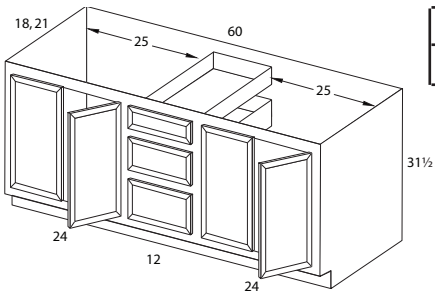

VSD60	1251	1321	1348	1363	1674
VSD6018	1251	1321	1348	1363	1675

- No shelf
- 1 Standard depth drawer & 2 deep drawers
- Butt doors
- 4 1/2" Toe kick



Item Description	A	B	C	D	E
	Concord Maple Franklin Maple	Concord RP Maple Dover Maple Franklin RP Maple	Albany Maple	Lawrence Maple Atlanta Maple	Atlanta RP Maple

Vanity Sink Base Extended Stiles, 31 1/2" High

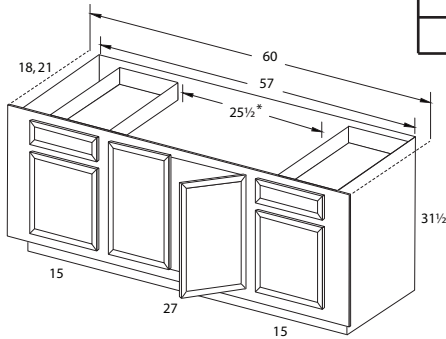

VSDE57	1251	1321	1348	1363	1674
VSDE5718	1251	1321	1348	1363	1675

- No shelf
- Butt doors
- Trimmable 1 1/2" per side
- 4 1/2" Toe kick

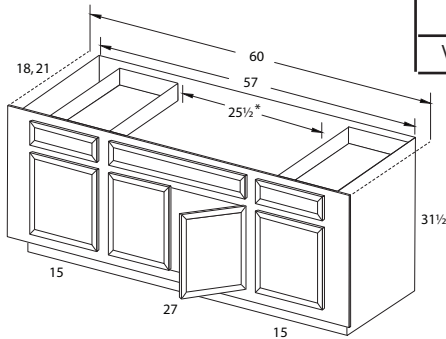

VSDE57B	1251	1321	1348	1363	1675
VSDE5718B	1251	1321	1348	1363	1675

- No shelf
- 1 Drawer blank
- Butt doors
- Trimmable 1 1/2" per side
- 4 1/2" Toe kick



Item Description	A	B	C	D	E
Concord Maple Franklin Maple		Concord RP Maple Dover Maple Franklin RP Maple	Albany Maple	Lawrence Maple Atlanta Maple	Atlanta RP Maple

Matching Vanity End Panel, 31 1/2" High

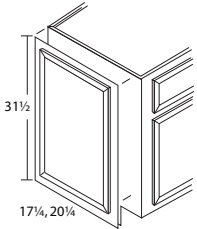

MVEP	164	207	212	215	247
MVEP18	164	207	212	215	247

- 3/16" Thick plywood panel
- Panel & door shipped loose
- Toe space field notched

Door Dimensions

	1/2" Overlay	Full Overlay
MVEP	18-1/2" W x 24-1/2" H	20-5/8" W x 26-5/8" H
MVEP18	15-1/2" W x 24-1/2" H	17-5/8" W x 26-5/8" H



Item Description	A	B	C	D	E
Concord Maple Concord RP Maple Dover Maple Franklin Maple Franklin RP Maple		Albany Maple		Atlanta Maple Atlanta RP Maple Lawrence Maple	

Vanity Knee Drawer

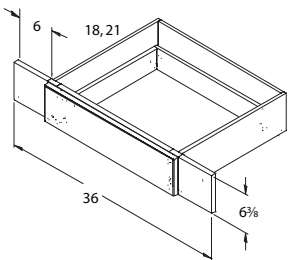

VKD36	155	158	192
VKD3618	155	158	192

- Trimmable to 24"
- Drawer wings shipped loose. Pocket screwed for easy installation



Item Description	Concord Maple Concord RP Maple Dover Maple Franklin Maple Franklin RP Maple	Albany Maple	Atlanta Maple Atlanta RP Maple Lawrence Maple
-------------------------	---	--------------	---

Vanity Drawer Base, 31 1/2" High

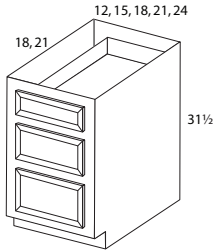

VDB12	618	630	667
VDB1218	618	630	667
VDB15	641	654	695
VDB1518	641	654	695
VDB18	653	666	708
VDB1818	653	666	708
VDB21	681	695	740
VDB2118	681	695	740
VDB24	703	717	768
VDB2418	703	717	768

- 1 Standard depth drawer
- 2 Deep drawers
- 4 1/2" Toe kick

Tall Vanity Triple Drawer Base, 34 1/2" High

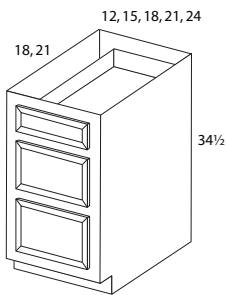

VTD12T	692	706	754
VTD1218T	692	706	754
VTD15T	721	735	789
VTD1518T	721	735	789
VTD18T	736	751	807
VTD1818T	736	751	807
VTD21T	770	785	844
VTD2118T	770	785	844
VTD24T	791	807	875
VTD2418T	791	807	875

- 1 Standard depth drawer
- 2 Deep drawers
- 4 1/2" Toe kick



Item Description	A	B	C	D	E
	Concord Maple Franklin Maple	Concord RP Maple Dover Maple Franklin RP Maple	Albany Maple	Lawrence Maple Atlanta Maple	Atlanta RP Maple

Tall Vanity Base, 34 1/2" High

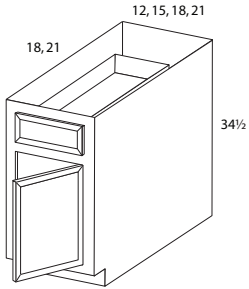

VB12T	289	309	316	320	371
VB1218T	289	309	316	320	371
VB15T	302	325	332	336	389
VB1518T	302	325	332	336	389
VB18T	350	377	385	390	451
VB1818T	350	377	385	390	451
VB21T	415	447	456	462	534
VB2118T	415	447	456	462	534

- No shelf
- Specify L/R hinge
- 4 1/2" Toe kick

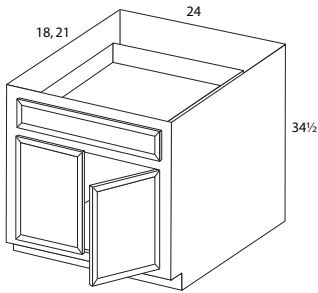

VB24T	479	516	527	534	616
VB2418T	479	516	527	534	616

- No shelf
- Butt doors
- 4 1/2" Toe kick

Tall Vanity Sink Base, 34 1/2" High

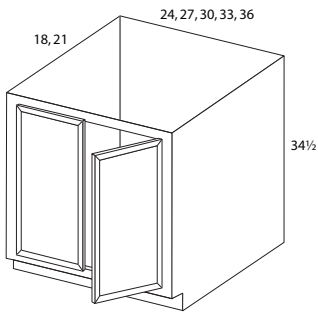

VS24T	426	459	469	476	550
VS2418T	426	459	469	476	550
VS27T	439	475	485	492	567
VS2718T	439	475	485	492	567
VS30T	441	478	488	495	571
VS3018T	441	478	488	495	571
VS33T	454	489	499	507	583
VS3318T	454	489	499	507	583
VS36T	466	500	510	519	599
VS3618T	466	500	510	519	599

- No shelf
- Butt doors
- 4 1/2" Toe kick



Item Description	A	B	C	D	E
Concord Maple Franklin Maple					
Concord RP Maple Dover Maple Franklin RP Maple					
Albany Maple					
Lawrence Maple Atlanta Maple					
Atlanta RP Maple					

Tall Vanity Sink Base with Drawer Blanks, 34 1/2" High

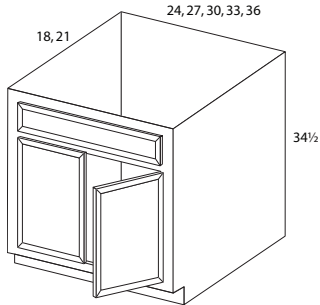

VS24BT	451	489	499	507	583
VS2418BT	451	489	499	507	583
VS27BT	466	502	513	521	602
VS2718BT	466	502	513	521	602
VS30BT	473	506	517	525	610
VS3018BT	473	506	517	525	610
VS33BT	484	522	533	539	623
VS3318BT	484	522	533	539	623
VS36BT	496	534	545	553	641
VS3618BT	496	534	545	553	641

- No shelf
- 1 Drawer blank; butt doors
- 4 1/2" Toe kick

Tall Vanity Sink Base with Drawers, 34 1/2" High

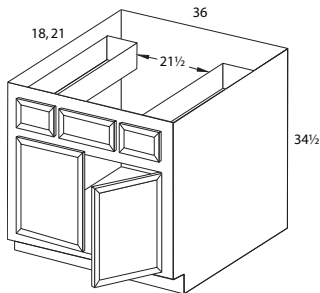

VSB36T	639	674	688	696	793
VSB3618T	639	674	688	696	793

- No shelf
- Butt doors
- 4 1/2" Toe kick

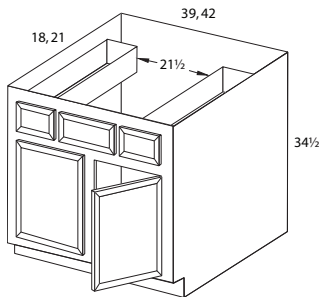

VSB39T	667	705	720	727	827
VSB3918T	667	705	720	727	827
VSB42T	692	734	749	757	860
VSB4218T	692	734	749	757	860

- No shelf
- 4 1/2" Toe kick

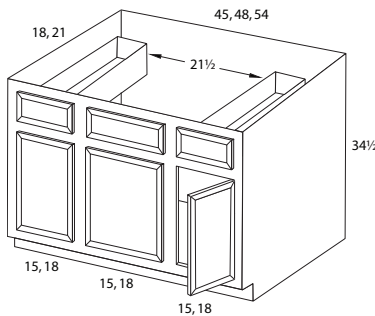

VSB45T	751	796	812	822	937
VSB4518T	751	796	812	822	937
VSB48T	769	815	832	840	960
VSB4818T	769	815	832	840	960
VSB54T	778	826	843	853	1048
VSB5418T	778	826	843	853	1048

- No shelf
- Doors hinged L, R, R
- 4 1/2" Toe kick



Item Description	A	B	C	D	E
Concord Maple Franklin Maple		Concord RP Maple Dover Maple Franklin RP Maple	Albany Maple	Lawrence Maple Atlanta Maple	Atlanta RP Maple

Tall Combination Vanity Sink Base, 34 1/2" High

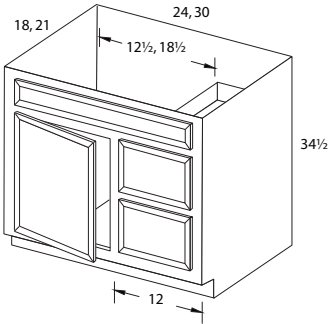

CVS24BT	683	723	738	746	850
CVS2418BT	683	723	738	746	850
CVS30BT	700	740	755	764	871
CVS3018BT	700	740	755	764	871

- No shelf
- 1 Drawer blank & 2 deep drawers
- Specify drawers L/R
- 4 1/2" Toe kick

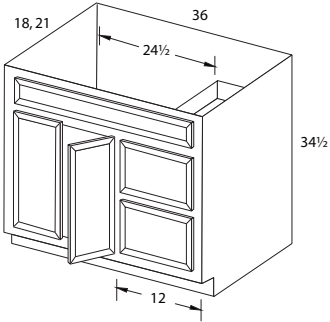

CVS36BT	732	774	790	799	912
CVS3618BT	732	774	790	799	912

- No shelf
- 1 Drawer blank & 2 deep drawers
- Specify drawers L/R
- Butt doors
- 4 1/2" Toe kick

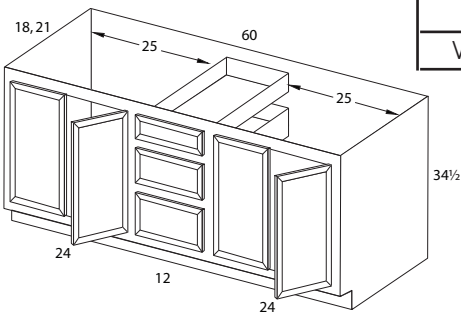

VSD60T	1428	1502	1533	1547	1827
VSD6018T	1428	1502	1533	1547	1877

- No shelf
- Butt doors
- 1 Standard depth drawer & 2 deep drawers
- 4 1/2" Toe kick



Item Description	A	B	C	D	E
Concord Maple Franklin Maple					
Concord RP Maple Dover Maple Franklin RP Maple					
Albany Maple					
Lawrence Maple Atlanta Maple					
Atlanta RP Maple					

Tall Vanity Sink Base Extended Stiles, 34 1/2" High

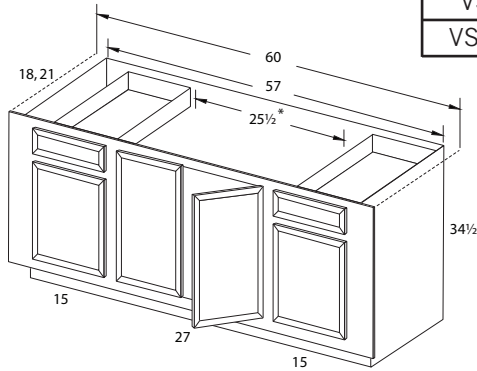

VSDE57T	1428	1502	1533	1547	1827
VSDE5718T	1428	1502	1533	1547	1877

- No shelf
- Butt doors
- Trimmable 1 1/2" per side
- 4 1/2" Toe kick

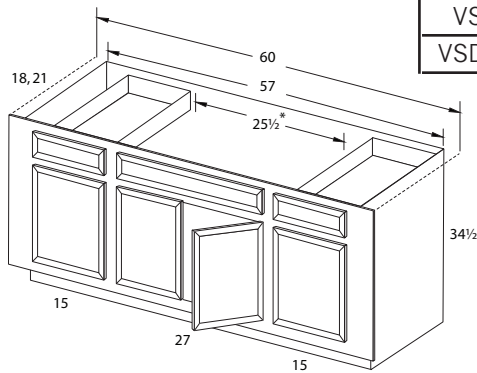

VSDE57BT	1428	1502	1533	1547	1827
VSDE5718BT	1428	1502	1533	1547	1877

- No shelf
- 1 Drawer blank
- Butt doors
- Trimmable 1 1/2" per side
- 4 1/2" Toe kick

Tall Matching Vanity End Panel, 34 1/2" High

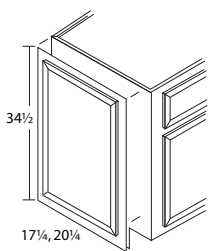

MVEPT	177	221	226	229	266
MVEP18T	177	221	226	229	266

- 3/16" Thick plywood panel
- Panel & door shipped loose
- Toe space field notched

Door Dimensions

	1/2" Overlay	Full Overlay
MVEPT	18-1/2" W x 27-1/2" H	20-5/8" W x 29-5/8" H
MVEP18T	15-1/2" W x 27-1/2" H	17-5/8" W x 29-5/8" H



Item Description	Maple
------------------	-------

Details **WFex**

Skins

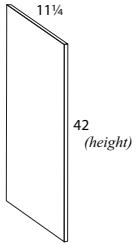

Wall Skins	
WS42	77

- 3/16" Thick plywood

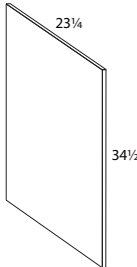

Base Skins	
BS	106

- 3/16" Thick plywood

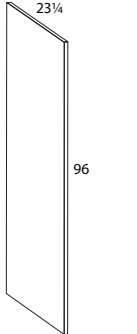

Utility Skins	
US2496	271

- 3/16" Thick plywood

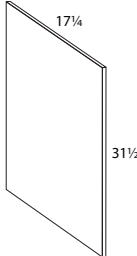

Vanity Skins	
VS	102
18VS	102

- 3/16" Thick plywood



Item Description

Maple

Details

WFex

DETAILS

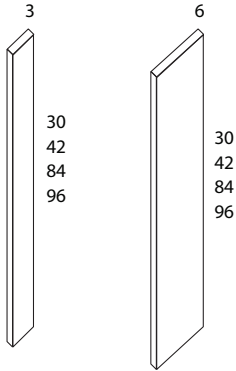

3 Inch Fillers

F3	44
F342	59
F384	92
F396	99

- Solid wood construction
- Finished on face and two edges

6 Inch Fillers

F6	71
F642	116
F684	180
F696	196

- Solid wood construction
- Finished on face and two edges

NEW
NEW

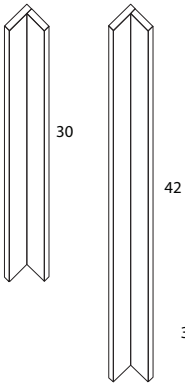

Corner Fillers

CF3	105
CF342	164

- Solid wood construction
- For 36" H, use 42" H and trim

WFex

Shelving

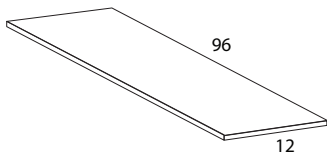

SHV	178
-----	-----

- 3/4" Thick hardwood veneer. Available in 96" length only
- Edgebanded on one side
- Long edge finished to match

WFex

Finished Back Panel

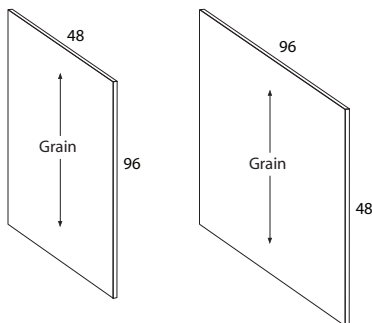

FBP4896	333
FBP9648	333

- 3/16" Thick hardwood veneer vertical grain
- Custom modifications not available



Item Description	Maple
-------------------------	-------

Details

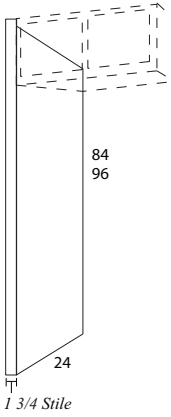

Refrigerator End Panel	
REP2484	214
REP2496	257

- 1/2" Hardwood veneer on one side & UV clear coat on other side w/ 1-3/4" solid wood stile

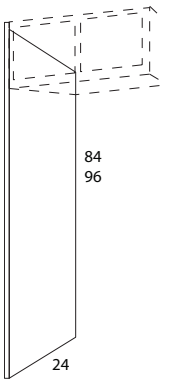

Refrigerator End Panel, 3/4"	
REP2484E	214
REP2496E	257

- 3/4" Hardwood veneer
- Finished on both sides & edgebanded on long sides

WFlex

4 1/2" High Toe Space Cover

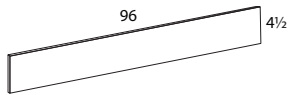

TSC4 1/2	44
----------	-----------

- 3/16" Thick hardwood veneer
- Required on all base, universal access, tall, vanity, & tall vanity cabinets

WFlex

Shelf Kits

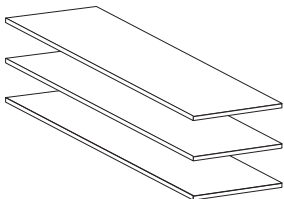

SK1812	82
SK1824	119
SK2412	112
SK2424	134
SK3612	132
SK3624	153

- 3/4" Hardwood veneer , edgebanded on one side
- Includes 3 shelves & 12 clips



Item Description

Maple

Details

WFex

DETAILS

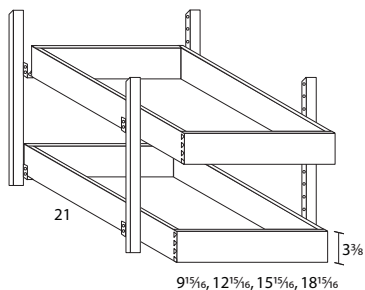

Sliding Shelf Kits	
SSK15	240
SSK18	255
SSK21	270
SSK24	286

- 2 Adj. shelves per kit
- 20" High Pilasters
- Dovetail construction with full extension, ball-bearing guides
- Depth modifications not available

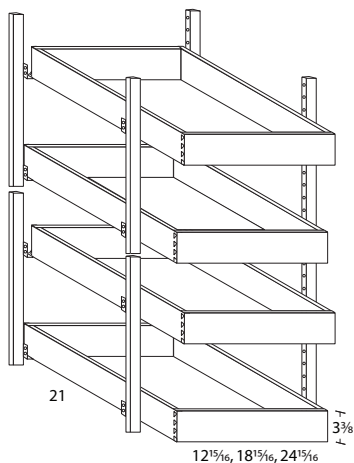

Utility Sliding Shelf Kits	
USK18	503
USK24	579
USK36	685

- 4 Adj. shelves per kit
- 20" High Pilasters
- Dovetail construction with full extension, ball-bearing guides
- Depth modifications not available

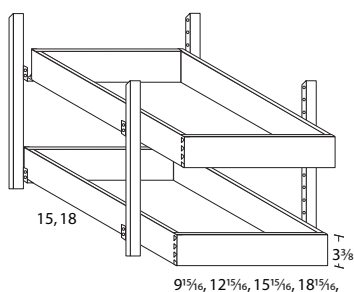

Vanity Sliding Shelf Kits	
VSSK15	228
VSSK1518	228
VSSK18	238
VSSK1818	238
VSSK21	248
VSSK2118	248
VSSK24	258
VSSK2418	258

- 2 Adj. shelves per kit
- 20" High Pilasters
- Dovetail construction with full extension, ball-bearing guides
- Depth modifications not available



Item Description

Maple

Moldings

WF_{Ex}

Scribe 3/4

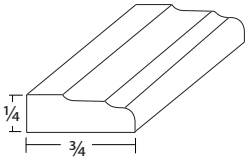

S3/4

28

Light Rail

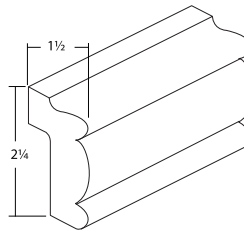

LRM

231

Scribe 1 1/4

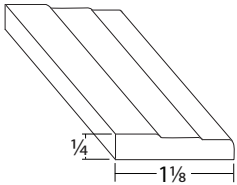

S1 1/4

33

Crown

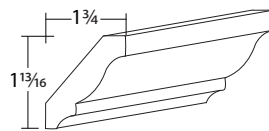

CM8

170

CM10

211

Corner 3/4

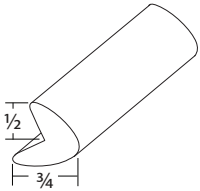

C3/4

42

Universal Crown

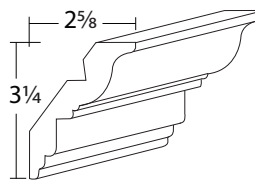

UCM8

203

Inside Corner 3/4

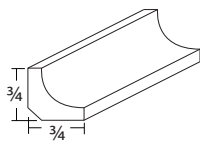

IC3/4

38

Small Cove

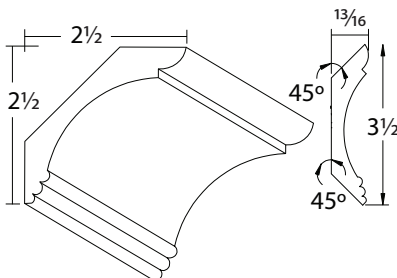

SCVMD

202

Batten 3/4

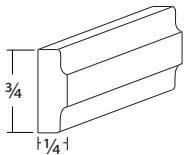

B3/4

33

Rope

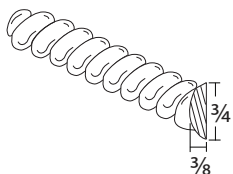

RM

67

• All moldings are 8 feet in length except where noted.



Item Description

Maple

Moldings

WF_{EX}

DETAILS

135° Inside

IM135

71

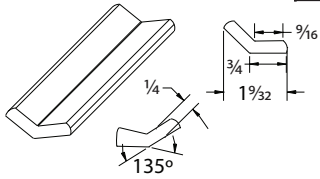

Round Base

RBM

202

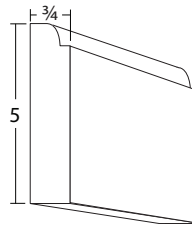

135° Outside

OM135

71

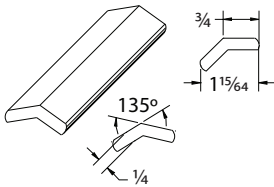

Base

BM

202

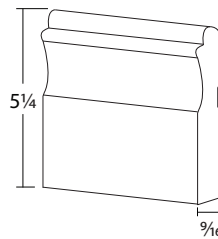

Shoe

SM

44

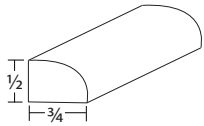

Cap

CAP

122

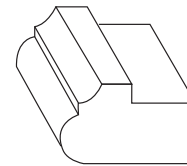
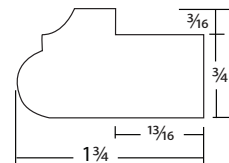

Counter Edge

CE

75

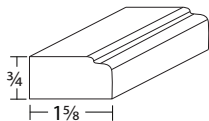

Outside Corner

OCM

123

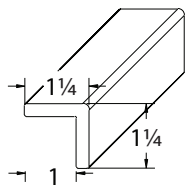

• Finished on both sides

• All moldings are 8 feet in length except where noted.



Item
Description

Maple

Sales Support Tools

Marketing Tools

Capital Series Price Book	PRICE	117
Capital Series Trifold • Available in pkg. of 10	TRI-CS	35
Sample Door • Specify door style and finish • Finish upcharge applies to order • Overall size: 12 1/2" x 15 1/2"	SD	101
Framed Sample Front • Specify door style and finish • Finish upcharge applies to order • Features a framed door and drawer front • Overall size: 15" x 24" • Labeled with door style, door overlay, wood species, and finish on the back	FSFK	233
Individual Color Block • 6" L x 2-3/4" W; 3/8" Thick • Specify finish on order • Each sample is labeled with wood specie, finish color and glaze on the back • Not available on Quick Ship	BLOCKS-M	12
Color Block Set • 6" L x 2-3/4" W; 3/8" Thick • Includes all 18 finishes • Not available on Quick Ship	CBK-CS	190

Large quantity orders may require additional lead-time.
Wellborn Forest Products reserves the right to update or change its Marketing Tools.



Item
Description

Sales Support Tools

Marketing Tools

Dealer Starter Kit

- Capital Series Dealer Starter Kit includes marketing materials and sales tools to get started
- (1) Price Book
- (1) Pk. of Literature
- (10) Pre-selected sample doors

Kit includes the following door styles:

- Albany Java
- Atlanta Honey Chocolate
- Atlanta Raised Panel Nutmeg
- Concord Arctic Chocolate
- Concord Raised Panel Rose'
- Dover Arctic
- Dover Champagne
- Franklin Rose' Shadow
- Lawrence Hazelnut
- Lawrence Ginger

DSK-CS

900

MARKETING TOOLS

Large quantity orders may require additional lead-time.



Item Description	A	B	C	D	E
	Concord Maple Franklin Maple	Concord RP Maple Dover Maple Franklin RP Maple	Albany Maple	Lawrence Maple Atlanta Maple	Atlanta RP Maple

Replacement Parts

W^{Flex}

Finishing & Replacement Parts

<p>Touch Up Kit</p> <ul style="list-style-type: none"> • Kit includes: <ul style="list-style-type: none"> (1) crayon (1) marker (1) scraper card (1) buffing pad • Available in all finishes 	TUK	69
<p>Pint of Stain</p> <ul style="list-style-type: none"> • Available in pints only • Available in all stains and all glazes • Paints not available 	STAIN	28
Cabinet Mounting Bracket - Left	SCFA_CML	3
Cabinet Mounting Bracket - Right	SCFA_CMR	3
Capital Full Access 12 in Drawer Guide Sets	SCFA15	90
Capital Full Access 15 in Drawer Guide Sets	SCFA18	90
Capital Full Access 18 in Drawer Guide Sets	SCFA21	90
Capital Full Access 21 in Drawer Guide Sets	SCFA24	90

Three Year Limited Warranty



Wellborn Forest Products Inc. warrants its products to the original consumer purchaser to be free from defects in material and workmanship under normal residential use for a period of three years of the original consumer purchaser. This warranty is non-transferable.

During this warranty period, Wellborn Forest Products will repair or replace, at our discretion, any cabinet or its component which proves to be defective in material and/or workmanship under normal installation, use and service. **This warranty is limited to the replacement of defective parts and does not include service, labor, or transportation charges related to the removal or installation of defective parts, regardless of whether work was performed by a contractor, Service Company or yourself. In addition, this warranty does not include labor or damage related to improper installation, storage, misuse or neglect.**

This warranty shall not apply to Americana Capital Series Cabinetry or parts that have been subjected to alteration, modification, accident, damage in transit, abnormal use, extreme temperature, moisture levels, or abrasive cleaning chemicals. Cabinet integrity is limited to the Kitchen Cabinet Manufacturers Association testing and certification standards which comply with the American National Standards Institute #A161.1-2000.

This warranty does not apply to any products used or installed in conjunction with Americana Capital Series Cabinets such as plumbing fixtures, counter tops, or appliances. Use of Americana Capital Series Cabinetry or parts contrary to instructions furnished by Wellborn Forest Products will void this warranty.

All claims for defective products must be submitted, in writing, to the Americana Capital Series dealer from whom you purchased this product, detailing the specific problem. Proof of purchase (a copy of the original invoice or dated sales receipt from an Americana Capital Series dealer) is required. Warranty claims must be initially made through your Americana Capital Series dealer. The Americana Capital Series dealer will present the warranty claims to Wellborn Forest Products. Wellborn Forest Products reserves the right to inspect the claimed defective cabinets to require that the replacements will be invoiced upon shipment and credit issued upon the return and inspection of defective product. If you need further assistance, please contact:

Wellborn Forest Products Inc.; Account Services/Warranty Claim; 2212 Airport Blvd.; Alexander City, AL 35010

Special considerations:

- a.) Doors that are warped 1/4" or less must be allowed to hang through two (2) season (ex. Spring, Summer) before replacement will be made. Typically, the door will return to its normal flat position after conditioning to its environment. Prior to requesting a replacement, please be sure that the problem is not an installation deficiency.
- b.) Finish deviations must be inspected by an authorized Wellborn Forest Products representative. Determination will be made following the inspection whether to repair in the field or to return the product to the factory for refinishing or replacement. No field repair may be made without approval from Wellborn Forest Products.
- c.) Stain variations: Since no two trees are the same, wood is a unique material with natural variations in grain, texture, and color. These variations may also cause considerable differences between old samples and new cabinets. Please Note: Newly produced cabinets will never be the same color as aged samples or cabinets.
- d.) Mitered doors: Mitered doors allow a .012" joint gap 1" from inside bead. Mitered doors are not warranted against joint separations that occur as a result of high humidity or moisture conditions. Painted finishes are not recommended on mitered designs.
- e.) Veneered panels: Veneered panel doors are not guaranteed to match solid wood framing on the same door in either the raw or finished state. Veneers will absorb stain differently than solid wood. The mismatch of solid and veneers is not considered defective.
- f.) Some replacement parts are subject to availability and may differ from those originally supplied as part of our ongoing product development process.

No dealer or agent of Wellborn Forest Products has any authority to change or enlarge the above warranty or Wellborn Forest Products' responsibility.

THE WARRANTY STATEMENTS CONTAINED IN THIS LIMITED WARRANTY SET FORTH THE ONLY EXPRESS WARRANTIES EXTENDED BY WELLBORN FOREST PRODUCTS FOR THE CABINETS. IN LIEU OF ALL OTHER WARRANTIES, THE PROVISIONS OF THE WARRANTY SHALL CONSTITUTE THE ENTIRE LIABILITY OF WELLBORN FOREST PRODUCTS AND THE PROPERTY OWNER'S EXCLUSIVE REMEDY FOR BREACH OF THE WARRANTY. WELLBORN FOREST PRODUCTS SHALL NOT BE LIABLE TO THE PROPERTY OWNER FOR INCIDENTAL OR CONSEQUENTIAL DAMAGES FOR BREACH OF AN EXPRESS OR IMPLIED WARRANTY ON THE CABINETS.

This warranty became effective February 2016, and covers cabinets ordered on or after February 2016. Cabinets ordered before February 2016, are covered by the warranty in effect at the time of purchase.

Some states do not allow the exclusion or limitation of incidental or consequential damages, so the above limitations or exclusions may not apply to you. This warranty gives you specific legal rights and you may also have other rights which vary from state to state.

MKT 045 2/2016



INDEX BY DESCRIPTION

	A			
Arch Canopy Wood Hood.....		34	Shelving	71
	B		Sink Front	39
Bar Bracket		35	Sink Front Flooring	45
Base Cabinets		36-37	Sink/Range Base Cabinets	37
Base Cabinet with Pullout Shelves		38	Skins - Base	70
Base End Panel		45	Skins - Utility	70
Base Lazy Susans		40	Skins - Vanity	70
Base Microwave Cabinet		44	Skins - Wall	70
Base Tray Divider Cabinet		36	Sliding Shelf Kits	73
Base Triple Drawer		38	Square Corner Wall	31
Blind Corner Wall		29-31	Straight Canopy Wood Hood	34
	C		Super Susan Base	42
Combination Vanity Sink Base		62		T
Combination Vanity Sink Drawer Base		62	Tall Combination Vanity Sink Base	68
Corner Blind Base		43	Tall Combination Vanity Sink Drawer Base	68
Corner Blind Sink Base		43	Tall Vanity Sink Base Extended Stiles	69
Corner Filler		71	Tall Vanity Sink Base with Drawer Blanks	67
Corner Sink Base		41	Tall Vanity Sink Base with Drawers	67
Corner Susan Base		41	Tall Vanity Base Cabinets	66
	D		Tall Vanity Sink Base Cabinets	66
Desk End Panel		45	Tall Vanity Triple Drawer Base	65
Diagonal Corner Wall		27	Toe Space Cover	72
Diagonal Corner Sink Base		42	Toe Space Cover - Universal Access	52
Diagonal Corner Sink Front		39	Touch Up Kit	76
Diagonal Corner Susan Wall		27	Trash Can Base Cabinet	44
Double Oven Cabinets		57	Trifold-Capital Series	76
	F			U
Fillers		71	Universal Access Base Cabinets	46
Finished Back Panel		71	Universal Access Base Cabinet with Full Height Door	47
	L		Universal Access Base Microwave	50
Liner (Canopy Wood Hood)		34	Universal Access Corner Blind Base	51
	M		Universal Access Corner Sink Base	49
Marketing Tools		76	Universal Access Diagonal Corner Sink Base	50
Matching End Panel - Base		44	Universal Access Drawer Base	48
Matching End Panel - Tall		59	Universal Access Oven Cabinets	53
Matching End Panel - Universal Access		52	Universal Access Floating Sink Base Cabinet	47
Matching End Panel - Vanity		64	Universal Access Super Susan Base	49
Matching End Panel - Vanity Tall		69	Universal Access Toe Space Cover	52
Matching End Panel - Wall		33	Universal Access Trash Base Cabinet	52
Microwave Wall		28	Universal Microwave Wall	28
Moldings		74-75	Utility Cabinets	58
	O			V
Oven Cabinets		56	Valance - Straight	35
Oven Cabinets - Universal Access		53	Vanity Base Cabinets	60
Oven Drawer		55	Vanity Drawer Base	65
	P		Vanity Knee Drawer	64
Peninsula Base Cabinets		40	Vanity Sink Base Cabinets	60
Peninsula Wall Cabinets		32	Vanity Sink Base Extended Stiles	63
Price Book - Capital Series		76	Vanity Sink Base with Drawer Blanks	61
	R		Vanity Sink Base with Drawers	61
Refrigerator End Panels		72	Ventilator (250 CFM)	34
Refrigerator Walls		26		W
Replacement Parts		77	Wall Cabinets	20-25
	S		Wine Racks	35
Sample Door Kit		76	Wood Hoods	34
Sample Doors		76		
Sample Front (Framed)		76		
Shelf Kits		72		